

THIS DOCUMENT IS SUBJECT TO CHANGE WITHOUT NOTICE. IT IS CONFIDENTIAL AND A PROPERTY OF AMPHENOL LTW. DISCLOSURE TO THIRD PARTY HAS TO BE AUTHORIZED BY AMPHENOL LTW.

REV.	ECN NO.	DATE	SIGN	DESCRIPTION
C	LEN-930836	2009/03/12	Doreen	Change plastic in the notes.
D	LEN1430211	2014/03/24	Arvin	Change Tolerance
E	C200482	2020/04/15	Ruru	△ X2

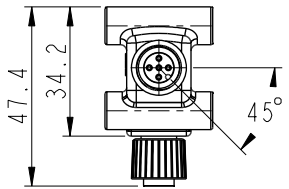

Conn. 1

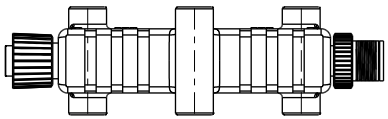
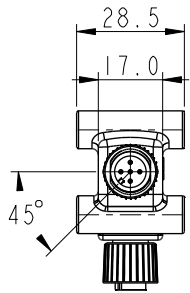
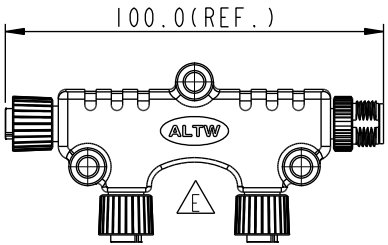

Conn. 4

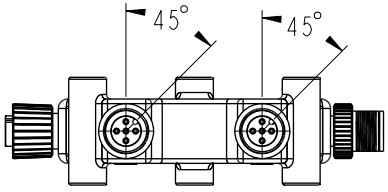
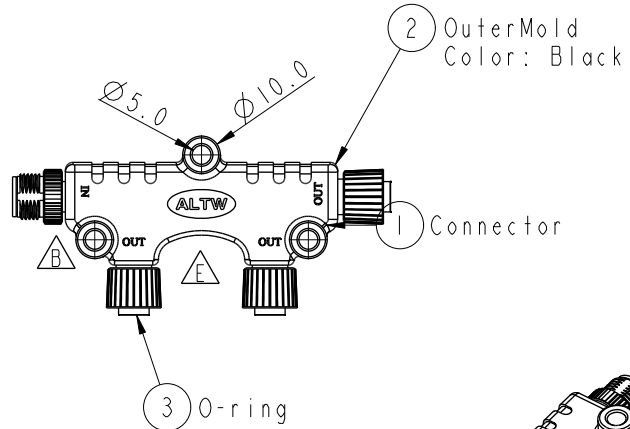

Conn. 2

Conn. 3

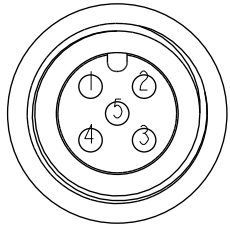
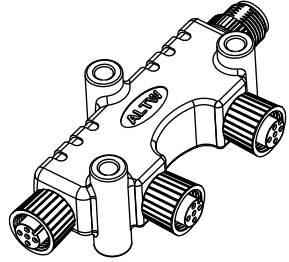

Conn. 1&2&3
Pin Assignments
Front View

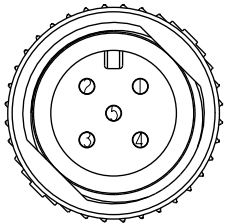

Conn. 4
Pin Assignments
Front View

Blue 藍 (22AWG)	5	5
White 白 (22AWG)	4	4
Black 黑 (22AWG)	3	3
Red 紅 (22AWG)	2	2
Green 綠 (22AWG)	1	1
Wire Color	Conn. 1	Conn. 4
Pin Out		

Note:

- * Ⓞ Important Dimension.
- * Waterproof Rate: IP68.
- * Connector: Black, PU&NY+GF.
- * O-Ring: Green, Viton.
- * Nut: Zinc Alloy, Nickel Plated.
- * Pin: Copper Alloy, Gold Plated.
- * Wire Harness: UL1007/TR64 22AWG, OD=0.76mm, Green, White, Blue, Red, Black.
- * Text Depth : 0.3 mm

UNIT:mm

TOLERANCE

△ ±0.5

TITLE			
NMEA2000 MICRO-C 2-WAY TEE			
SCALE	SIZE	SHEET OF	
1:2	A4	1 OF 1	
REV.	WC-REV.	QC: Inspection item	
E	B.2		

Amphenol LTW

安費諾亮泰企業股份有限公司

ITEM NO	S-555500-FFFFM00-S001
DWG NO	S-555500-FFFFM00-S001
CUSTOMER	ALTW

DRAWN BY	Arvin_chan
CHECKED BY	Jimmy
APPROVED BY	Jo-anne

DATE	2014-03-24
DATE	2014-03-24
DATE	2014-03-24