

THIS DOCUMENT IS SUBJECT TO CHANGE WITHOUT NOTICE. IT IS CONFIDENTIAL AND A PROPERTY OF Amphenol LTW. DISCLOSURE TO THIRD PARTY HAS TO BE AUTHORIZED BY Amphenol LTW.

REV.	ECN NO.	DATE	SIGN	DESCRIPTION
B	LEN1741292	2017/04/18	Vicky	Update Logo

ALTW
 CONFIDENTIAL
 2017-04-18
 R&D DEPT.

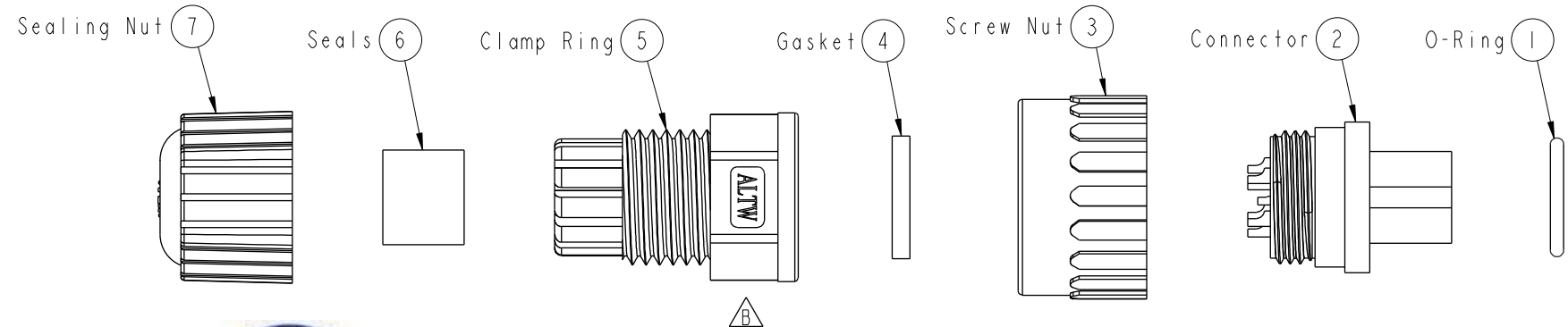

ALTW
 DCC. DEPT.
 CONFIDENTIAL
 2017.04.26
 ISSUED

- Note:
- * \varnothing Important Dimension
 - * Waterproof Rate: IP67
 - * Seals for Cable OD: $\varnothing 5.5\text{mm} \sim \varnothing 10.8\text{mm}$
(防水墊圈限用線徑: $\varnothing 5.5\text{mm} \sim \varnothing 10.8\text{mm}$)
 - * One Set Unassembled in One LTW Sealed Bag
(每一組未組裝, 放置於一個 Amphenol LTW 封口袋)
 - * Housing: Nylon+GF, Black
 - * Female Pin: Copper Alloy, Gold Plated
 - * O-Ring: EPDM, Black
 - * Screw Nut: Nylon+GF, Black
 - * Gasket: Silicone, Black
 - * Clamp Ring: Nylon, Black
 - * Seals: EPDM, Black
 - * Sealing Nut: Nylon, Black
 - * Liquid Glud :Claer

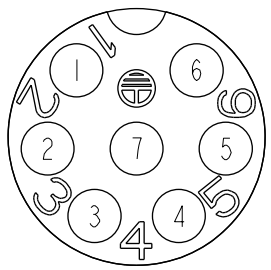
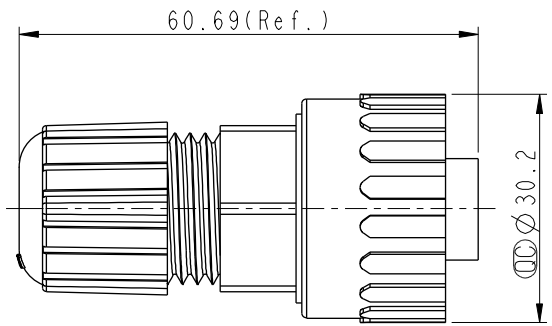

Pin Assignments
Front View

UNIT:mm	
TOLERANCE	$\pm 0.5 \text{ mm}$

TITLE Power Assy Screw 7Pin F Conn F Pin			
SCALE 1:1	SIZE A4	SHEET 1 OF 1	
REV. B	WC-REV. A.2	\varnothing : Inspection item	

Amphenol LTW
 安費諾亮泰企業股份有限公司

ITEM NO PWE-07BFFA-SL7001	DRAWN BY Vicky	DATE 2017-04-18
DWG NO PWE-07BFFA-SL7001	CHECKED BY Rita	DATE 2017-04-18
CUSTOMER ALTW	APPROVED BY Max	DATE 2017-04-18