

THIS DOCUMENT IS SUBJECT TO CHANGE WITHOUT NOTICE. IT IS CONFIDENTIAL AND A PROPERTY OF Amphenol LTW. DISCLOSURE TO THIRD PARTY HAS TO BE AUTHORIZED BY Amphenol LTW.

REV.	ECN NO.	DATE	SIGN	DESCRIPTION
A	Initial Released	2019/11/08	Brady	Initial Released.
B	C201548	2020/10/13	Vicky	$\triangle$ B XI
C	C210211	2021/03/22	Ruru	$\triangle$ C XI

$\triangle$ B  
MSDS-XXBFFM-SR8DXX  
XX: No. Of Pin  
XX: 01~99Meters  
01: 01Meter  
02: 02Meters  
.  
99: 99Meters

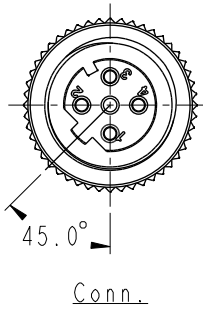
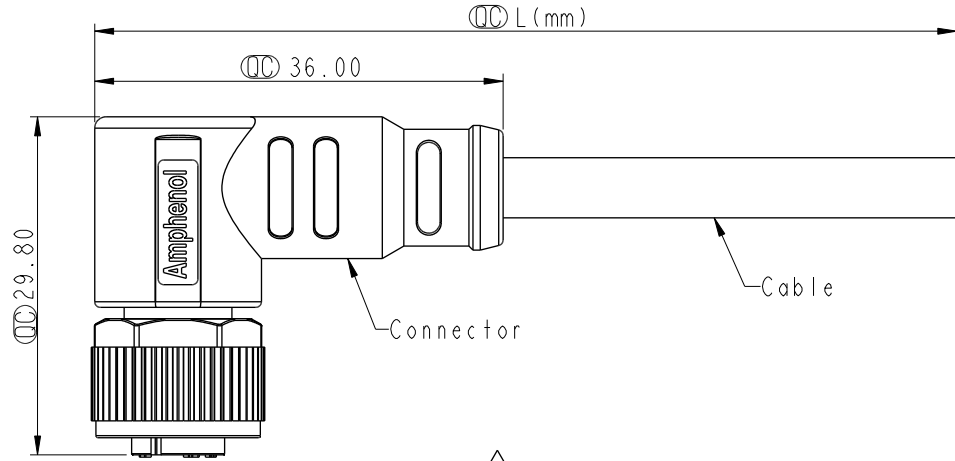
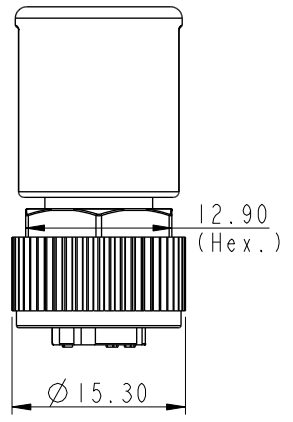

- $\triangle$ Note:
- \* RoHS Compliant
  - \*  $\phi$  Important dimension
  - \* Waterproof rate: IPX8, mated 1m/24h
  - \* Connector
  - Housing: Thermoplastic, Black
  - Pin: Copper alloy, Gold plated
  - O-Ring: Rubber, Gray
  - Nut: Metal
  - Shield: Metal
  - Outer mold: Thermoplastic, Black
  - \* Cable: UL2517, Shield, 22#\*4C+AL/MY+B, OD=5.3, PVC Jacket, Black
  - \* Cable length tolerance: 1M: +50/-0 mm  
1M < L  $\leq$  3M: +100/-0 mm  
3M < L  $\leq$  5M: +150/-0 mm  
5M < L  $\leq$  10M:  $\pm$ 100 mm  
10M < L  $\leq$  20M:  $\pm$ 200 mm  
20M < L  $\leq$  30M:  $\pm$ 300 mm  
30M < L  $\leq$  99M:  $\pm$ 500 mm

Pin Out	Shield	Braid
4	Black	黑
3	Blue	藍
2	White	白
1	Brown	棕
Pin #	Wire	

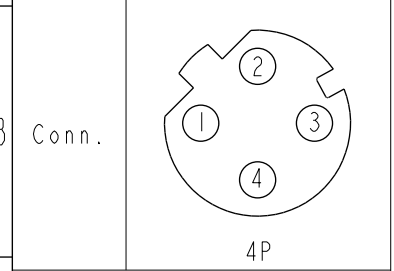

Pin Assignments Front View

UNIT:mm	
TOLERANCE	$\pm$ 0.5mm

TITLE N SEN, M12 B -SHLD, SCREW CABLE W/O SR, F, F, MOLDING			
SCALE 3:2	SIZE A4	SHEET 1 OF 1	
REV. C	WC-REV. A.5	$\phi$ Inspection item	

**Amphenol LTW**  
安費諾亮泰企業股份有限公司

ITEM NO	DRAWN BY Brady Chung	DATE 2019/11/08
DWG NO MSDS-XXBFFM-SR8DXX	CHECKED BY Jane Wang	DATE 2019/11/08
CUSTOMER ALTW	APPROVED BY Neo Tsai	DATE 2019/11/08