

THIS DOCUMENT IS SUBJECT TO CHANGE WITHOUT NOTICE. IT IS CONFIDENTIAL AND A PROPERTY OF Amphenol LTW. DISCLOSURE TO THIRD PARTY HAS TO BE AUTHORIZED BY Amphenol LTW.

REV.	ECN NO.	DATE	SIGN	DESCRIPTION
A	Initial Released	2019/11/08	Brady	Initial Released.
B	C210211	2021/03/19	Ruru	$\triangle B$ X2

$\triangle B$
MSBS-XXBFFM-SR8DXX

XX: No. Of Pin

XX: 01~99Meters
01: 01Meter
02: 02Meters
⋮
99: 99Meters

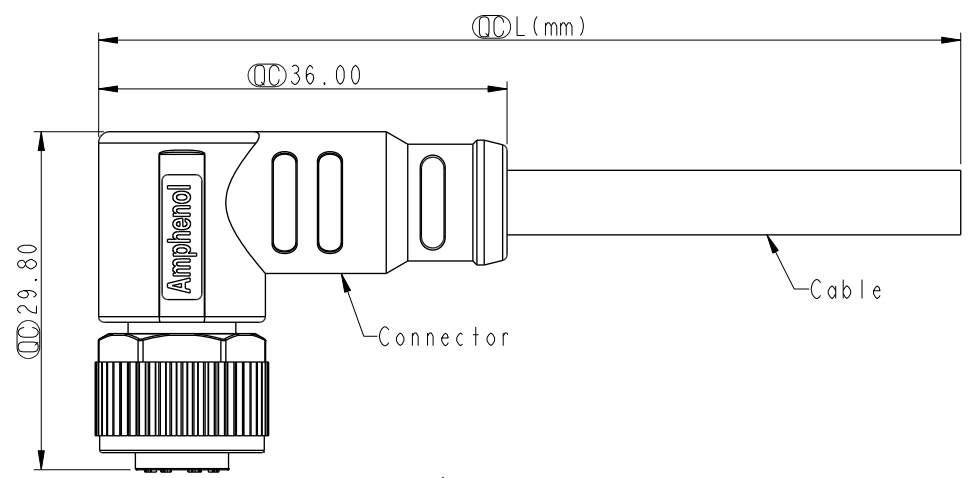
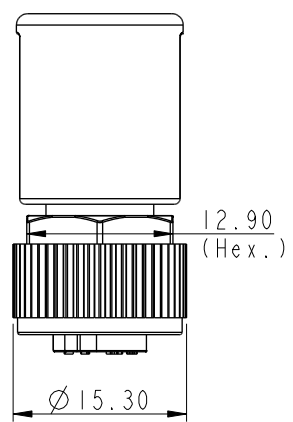

Pin Out	Braid	Shield
5	Gray	灰
4	Black	黑
3	Blue	藍
2	White	白
1	Brown	棕

Pin #	Wire
5	Gray
4	Black
3	Blue
2	White
1	Brown

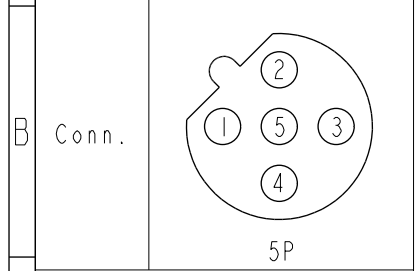

Pin Assignments Front View

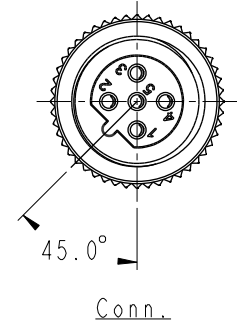

- $\triangle B$ Note:
- * RoHS Compliant
 - * ϕ Important dimension
 - * Waterproof rate: IPX8, mated 1m/24h
 - * Connector
 - Housing: Thermoplastic, Black
 - Pin: Copper alloy, Gold plated
 - O-Ring: Rubber, Gray
 - Nut: Metal
 - Shield: Metal
 - Outer mold: Thermoplastic, Black
 - * Cable: UL2517, Shield, 22#*5C+AL/MY+B, OD=5.7, PVC Jacket, Black
 - * Cable length tolerance:
 - 1M < L \leq 3M: +100/-0 mm
 - 3M < L \leq 5M: +150/-0 mm
 - 5M < L \leq 10M: ± 100 mm
 - 10M < L \leq 20M: ± 200 mm
 - 20M < L \leq 30M: ± 300 mm
 - 30M < L \leq 99M: ± 500 mm

UNIT:mm		
TOLERANCE		
± 0.5 mm		

TITLE N SEN, M12 B -SHLD, SCREW CABLE W/O SR, F, F, MOLDING			
SCALE 3:2	SIZE A4	SHEET 1 OF 1	
REV. B	WC-REV. A.5	ϕ Inspection item	

Amphenol LTW
安費諾亮泰企業股份有限公司

ITEM NO	DRAWN BY Brady Chung	DATE 2019/11/08
DWG NO MSBS-XXBFFM-SR8DXX	CHECKED BY Jane Wang	DATE 2019/11/08
CUSTOMER ALTW	APPROVED BY Neo Tsai	DATE 2019/11/08