

THIS DOCUMENT IS SUBJECT TO CHANGE WITHOUT NOTICE. IT IS CONFIDENTIAL AND A PROPERTY OF AMPHENOL LTW. DISCLOSURE TO THIRD PARTY HAS TO BE AUTHORIZED BY AMPHENOL LTW.

REV.	ECN NO.	DATE	SIGN	DESCRIPTION
B	LEN1741285	2017/04/20	Vicky	Update Logo

ALTW
 CONFIDENTIAL
 2017-04-20
 R&D DEPT.

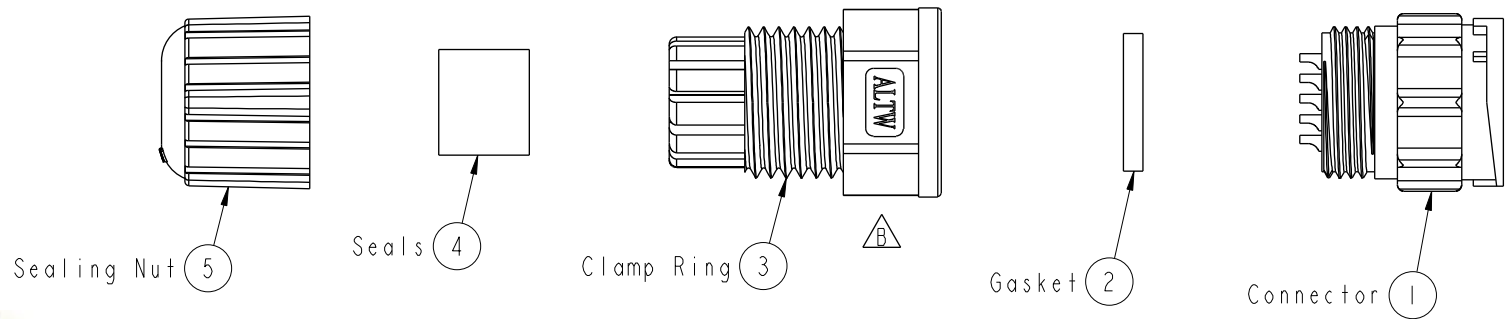

ALTW
 DCC. DEPT.
 CONFIDENTIAL
 2017.04.26
 ISSUED

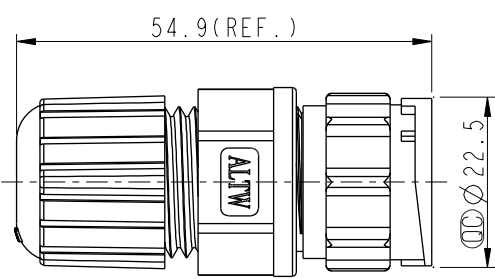

Pin Assignments
Front View

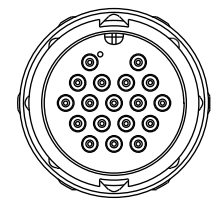

Conn

- Note:
- * \varnothing Important Dimension
 - * Waterproof Rate: IP67
 - * Housing: Nylon+GF, Black
 - * Male Pin: Copper Alloy, Gold Plated
 - * Gasket: Silicone, Black
 - * Clamp Ring: Nylon+GF, Black
 - * Sealing Nut: EPDM, Black
 - * Seal: EPDM, Black
 - * Seals For Cable OD: \varnothing 5.5mm~10.8mm

UNIT:mm

TOLERANCE	
.X	±0.25
.XX	±0.1
.XXX	±0.05
ANGLES	±1°

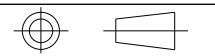

TITLE Assy Lock 18Pin M Conn M Pin			
SCALE 1:1	SIZE A4	SHEET 1 OF 1	
REV. B	WC-REV. A.2	QC: Inspection item	

Amphenol LTW
 安費諾亮泰企業股份有限公司

ITEM NO. DD-18BMMA-LL7001	DRAWN BY Vicky	DATE 2017-04-20
DWG NO. DD-18BMMA-LL7001	CHECKED BY Rita	DATE 2017-04-20
CUSTOMER ALTW	APPROVED BY Max	DATE 2017-04-20

DATE 2017-04-20
DATE 2017-04-20
DATE 2017-04-20

DATE 2017-04-20
DATE 2017-04-20
DATE 2017-04-20