

THIS DOCUMENT IS SUBJECT TO CHANGE WITHOUT NOTICE. IT IS CONFIDENTIAL AND A PROPERTY OF Amphenol LTW. DISCLOSURE TO THIRD PARTY HAS TO BE AUTHORIZED BY Amphenol LTW.

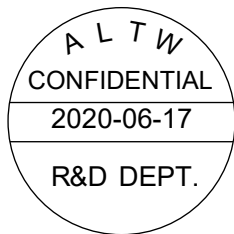

REV.	ECN NO.	DATE	SIGN	DESCRIPTION
B	LEN1741323	2017/04/24	Ruru	Change Logo
C	C200915	2020/06/17	Ruru	$\triangle C$ X3

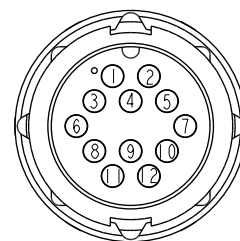
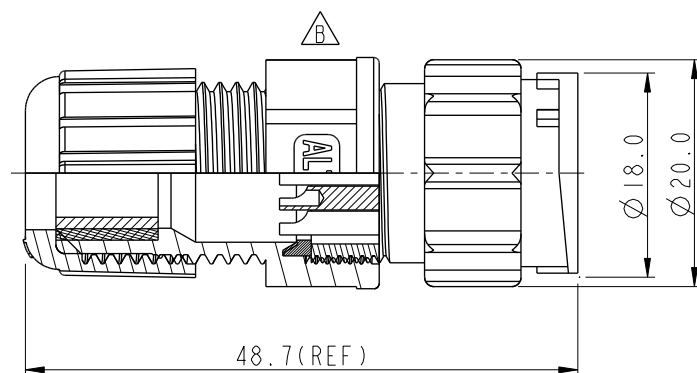
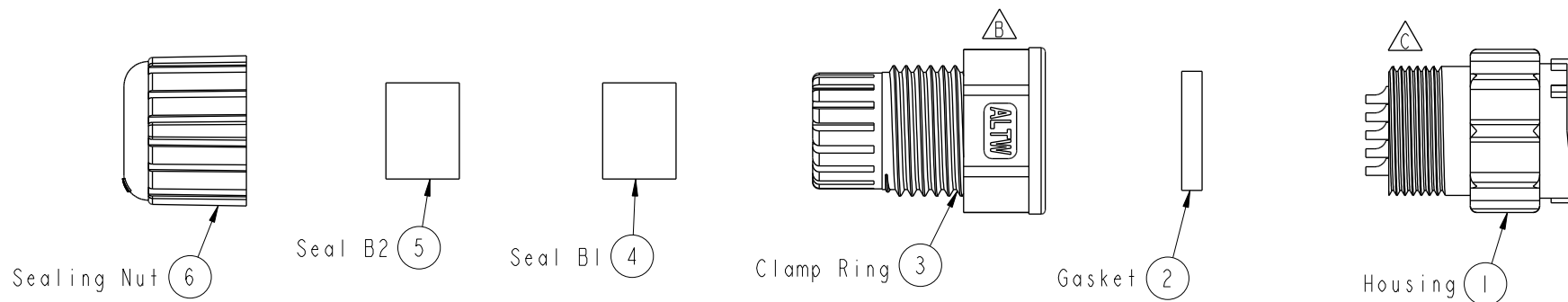

Pin Assignments  
Front View

$\triangle C$  Note:

- \*  $\text{QC}$  Important Dimension To Check.
- \* Waterproof Rate: IP67
- \* Housing: Thermoplastic, Black
- \* Male Pin: Copper Alloy, Gold Plated
- \* Gasket: Rubber, Black
- \* Clamp Ring: Thermoplastic, Black
- \* Seals1: Rubber, Black
- \* Seals2: Rubber, Black
- \* Sealing Nut: Thermoplastic, Black
- \* Seal B1 for Cable OD:  $\varnothing 7.6\text{mm} \sim \varnothing 9.6\text{mm}$
- \* Seal B2 for Cable OD:  $\varnothing 4.0\text{mm} \sim \varnothing 7.6\text{mm}$
- \* One Set Unassembled in One PE Bag

UNIT: mm		TITLE O CERES, C-5A, 12P, CABLE W/O SR M, M, FI SOLDER, 2LOCK		ITEM NO CD-12BMMA-LL7001		DRAWN BY Ruru		DATE 2017-04-24	
TOLERANCE .X $\pm 0.25$ .XX $\pm 0.1$ .XXX $\pm 0.05$ ANGLES $\pm 1^\circ$		SCALE 1:1		DWG NO CD-12BMMA-LL7001		CHECKED BY Rita		DATE 2017-04-24	
REV. C		WC-REV. A.2		CUSTOMER ALTW		APPROVED BY Max		DATE 2017-04-24	
		$\text{QC}$ : Inspection item							

Amphenol LTW  
安費諾亮泰企業股份有限公司