

THIS DOCUMENT IS SUBJECT TO CHANGE WITHOUT NOTICE. IT IS CONFIDENTIAL AND A PROPERTY OF AMPHENOL LTW. DISCLOSURE TO THIRD PARTY HAS TO BE AUTHORIZED BY AMPHENOL LTW.

REV.	ECN NO.	DATE	SIGN	DESCRIPTION
B	E191825	2019/11/05	Ruru	$\triangle B$ X4

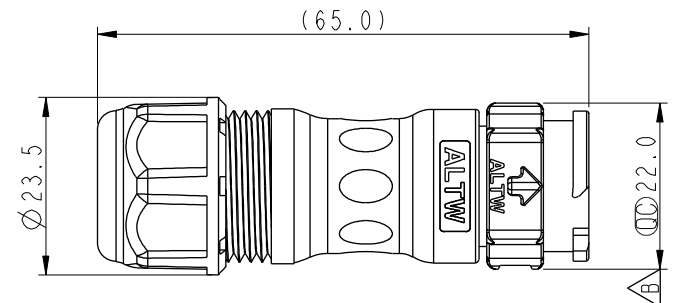
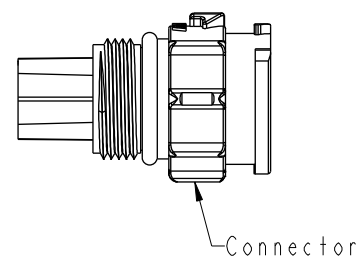
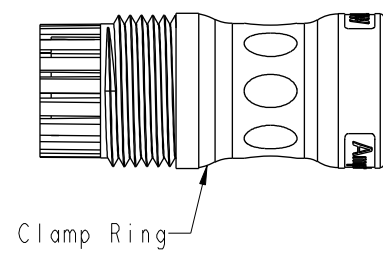
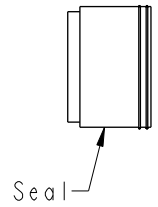
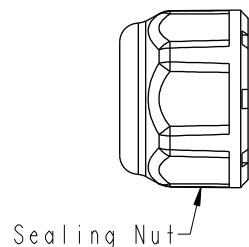

CB-XXBMFA-QL8XP0

04-4 Pin  
 05-5 Pin

S: With Red Color Seal 1, Cable OD 6.0~8.0mm.  
 M: With Yellow Color Seal 2, Cable OD 8.0~10.0mm.  
 L: With Blue Color Seal 3, Cable OD 10.0~12.0mm.  
 A: With Seal 1 & Seal 2 & Seal 3.

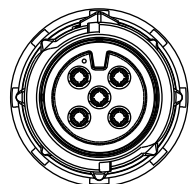
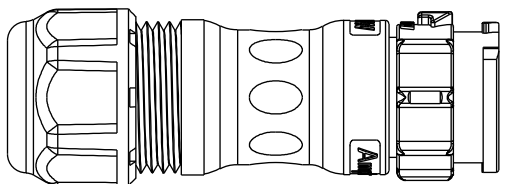

Pin Assignments Front View



- $\triangle B$  Note:
- \*  $\varnothing$  Important Dimension
  - \* Waterproof Rate: IP68, Mated  
 IP68 : 1M Depth Of Water In 24hours
  - \* Housing: Thermoplastic, Black
  - \* Pin: Copper Alloy, Gold Plated
  - \* Clamp Ring: Thermoplastic, Black
  - \* Sealing Nut: Thermoplastic, Black
  - \* Seals: Rubber

A	UNIT:mm	$\varnothing$	$\nabla$	TITLE	Amphenol LTW 安費諾亮泰企業股份有限公司	ITEM NO	DRAWN BY	DATE			
	TOLERANCE	$\pm 0.5$ mm		XLOK, C-10A, CABLE W/O SR, M, F, FI CRIMP, XLOK $\triangle B$		DWG NO	CB-XXBMFA-QL8XP0 $\triangle B$	Ruru	2019-11-05		
	SCALE	1:1	SIZE	A4		SHEET	1	OF	1	CHECKED BY	Rita
REV.	B	WC-REV.	A.1	$\varnothing$ Inspection item	CUSTOMER	ALTW	APPROVED BY	Max	DATE	2019-11-05	