



3311

FEMALE MANIFOLD BSP PARALLEL AND METRIC

[Description](#)
[Dimensions](#)
[Specifications](#)
[CAD drawings](#)
[Related products](#)

maximum working pressure	bar 20	MPa 2	psi 290
working temperature	°C (Celsius) From -10 to 80	F (Fahrenheit) From 14 to 176	K (Kelvin) From 263 to 353
body	anodized aluminium		

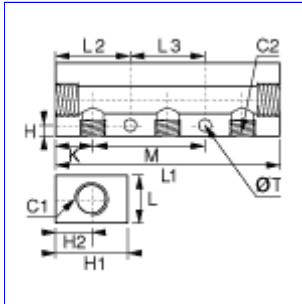

3311 FEMALE MANIFOLD BSP PARALLEL AND METRIC

[Zoom](#)

[Description](#)
[Dimensions](#)
[Specifications](#)
[CAD drawings](#)
[Related products](#)

convert weight standard : [kg](#) | [oz](#)

convert dimensions : [mm](#) | [inch](#)

		C1	C2	H (mm)	H1 (mm)	H2 (mm)	K (mm)	L (mm)	L1 (mm)	L2 (mm)	L3 (mm)	M (mm)	ØT (mm)	(kg)
3311 10 13 02	G1/4	G1/8	4,5	30,0	15,0	15,5	20,0	61,0	5,5	50,0	30,0	5,0	0,079	
3311 10 13 03	G1/4	G1/8	4,5	30,0	15,0	15,5	20,0	91,0	30,5	30,0	30,0	5,0	0,121	
3311 10 13 04	G1/4	G1/8	4,5	30,0	15,0	15,5	20,0	121,0	30,5	60,0	30,0	5,0	0,160	
3311 10 13 05	G1/4	G1/8	4,5	30,0	15,0	15,5	20,0	151,0	30,5	90,0	30,0	5,0	0,202	
3311 10 13 06	G1/4	G1/8	4,5	30,0	15,0	15,5	20,0	181,0	30,5	120,0	30,0	5,0	0,244	
3311 13 17 02	G3/8	G1/4	6,0	30,0	11,0	19,0	20,0	74,0	6,5	61,0	36,0	6,5	0,076	
3311 13 17 03	G3/8	G1/4	6,0	30,0	11,0	19,0	20,0	110,0	37,0	36,0	36,0	6,5	0,121	
3311 13 17 04	G3/8	G1/4	6,0	30,0	11,0	19,0	20,0	146,0	37,0	72,0	36,0	6,5	0,166	
3311 13 17 05	G3/8	G1/4	6,0	30,0	11,0	19,0	20,0	182,0	37,0	108,0	36,0	6,5	0,212	
3311 13 17 06	G3/8	G1/4	6,0	30,0	11,0	19,0	20,0	218,0	37,0	144,0	36,0	6,5	0,256	
3311 19 10 07	G1/8	M5x0,8	4,0	20,0	10,0	10,5	15,0	117,0	21,5	52,5	16,0	5,0	0,065	