

DWG. NO.  
SD-54593-004

F

D

V

C

B

DO NOT SCALE DRAWING

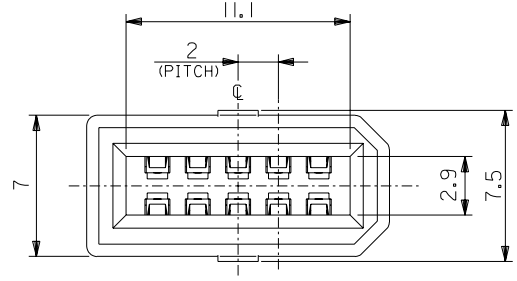
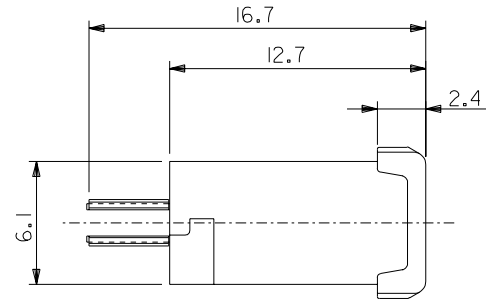
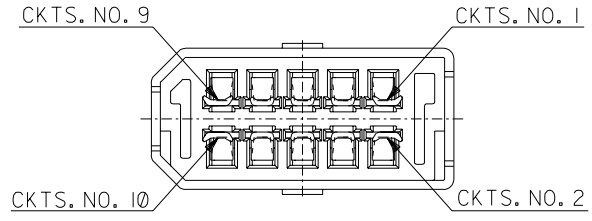
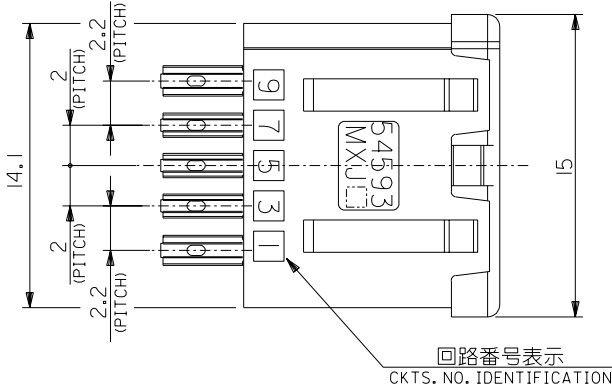

注記  
NOTES

1. 材質  
MATERIAL

ハウジング：ガラス入り耐熱樹脂 UL94V-0 色：黒  
HOUSING：G.F. HEAT RESISTANT PLASTIC UL94V-0 COLOR：BLACK  
ターミナル：りん青銅 t0.3  
TERMINAL：PHOSPHOR BRONZE t0.3

2. ヌッキ仕様  
PLATING

接点部：金メッキ0.3µmMIN.  
CONTACT AREA：GOLD 0.3µmMIN.  
下地メッキ：ニッケルメッキ2µmMIN.  
UNDER-PLATING：NICKEL 2µmMIN.  
結線部：錫メッキ1.0µmMIN.  
WIRE TERMINATION AREA：TIN 1.0µmMIN.

3. 適用電線範囲：AWG #18MAX. (回路番号1, 2, 9, 10)  
AWG #22MAX. (回路番号3~8)

APPLECABLE WIRES：AWG#18 MAX.(CKT.No.1,2,9,10)  
AWG#22 MAX.(CKT.No.3~8)

4. 被覆外径：φ1.6mmMAX. (回路番号1, 2, 9, 10)  
φ1.2mmMAX. (回路番号3~8)

INSULATION O.D：φ1.6 mmMAX.(CKT.No.1,2,9,10)  
φ1.2 mmMAX.(CKT.No.3~8)

5. 適用シエルカバー：58935-1028  
APPLECABLE SHELL COVER：58935-1028

6. 適用シエルボディ：58934-1028  
APPLECABLE SHELL BODY：58934-1028

7. 本製品は54593-1011の鉛フリー品である。  
THIS PRODUCT IS LEAD FREE OF 54593-1011.

54593-1019	54593-***19
MATERIAL.NO	MODEL.NO

DIMENSIONS:		SHT	REV
<input type="checkbox"/> mm	<input type="checkbox"/> INCH	<input checked="" type="checkbox"/> mm ONLY	REVISE ON CAD ONLY

EC NO. DRWN: CHK: APPR:	EC NO. DRWN: CHK: APPR:	EC NO. DRWN: CHK: APPR:	EC NO. DRWN: CHK: APPR:
RELEASED:04/04/14	EC NO. J2004-3790	DRWN: M.NABEI	CHK: K.TOJO
		APPR: M.SASAO	

MATERIAL 材料	注記参照 SEE NOTES.
FINISH 仕上げ	注記参照 SEE NOTES
WIRE RANGE 適用電線範囲	注記参照 SEE NOTES
INS. RANGE 被覆外径	注記参照 SEE NOTES

GENERAL TOLERANCES: (UNLESS SPECIFIED) 一般公差	SCALE 4-1	DESIGN UNITS <input checked="" type="checkbox"/> mm <input type="checkbox"/> INCH
10 UNDER 未満	±0.2	
10 OVER 30 UNDER 以上 未満	±0.25	
30 OVER 以上	±0.3	
ANGLE 角度	±3°	

DRAWN BY & DATE M.NABEI 04/04/14	THIRD ANGLE PROJECTION	TITLE: 2.0 I/O HAND/S TYPE PLUG HS'G ASS'Y -LEAD FREE-
CHECKED BY & DATE K.TOJO 04/04/14	MOLEX MOLEX INCORPORATED	
APPROVED BY & DATE M.SASAO 04/04/14	CAD FILENAME SD-54593-004.S01	MATERIAL NO. SD-54593-004
THIS DRAWING CONTAINS INFORMATION THAT IS PROPRIETARY TO MOLEX INCORPORATED AND SHOULD NOT BE USED WITHOUT WRITTEN PERMISSION.		SHEET NO. 1 OF 1 SIZE B