

DO NOT
SCALE FROM
THIS PRINT

No. OF POSITIONS
-026, -052, 078
(PER ROW)

SOLDER TAIL LEAD STYLE
-01: 1.57[.062] OR
2.36[.093] BOARD
(SEE NOTE 9)

PACKAGING

BLANK: TRAY(SEE NOTE 16)
-TR: TAPE & REEL
(SEE NOTE 17 & 18)
(NOT AVAILABLE FOR -78 POS)
-FR: FULL REEL QTY TAPE & REEL
(SEE NOTE 17 & 18)
PICK & PLACE OPTION
-K: POLYIMIDE FILM
(NOT AVAILABLE FOR
-026 & -078)
(USE K-DOT-.276-.375-.005,
SEE FIG. 2, SHT 6)

GUIDE POSTS

-GP
RIGHT ANGLE

PLATING SPECIFICATION

-S: 30µ" SELECTIVE GOLD IN CONTACT AREA
MATTE TIN ON TAIL
(USE T-1M52-XX-S & IM-T-1G35-XX-S)
-L: 10µ" SELECTIVE GOLD IN CONTACT AREA
MATTE TIN ON TAIL
(USE T-1M52-XX-L & IM-T-1G35-XX-L)

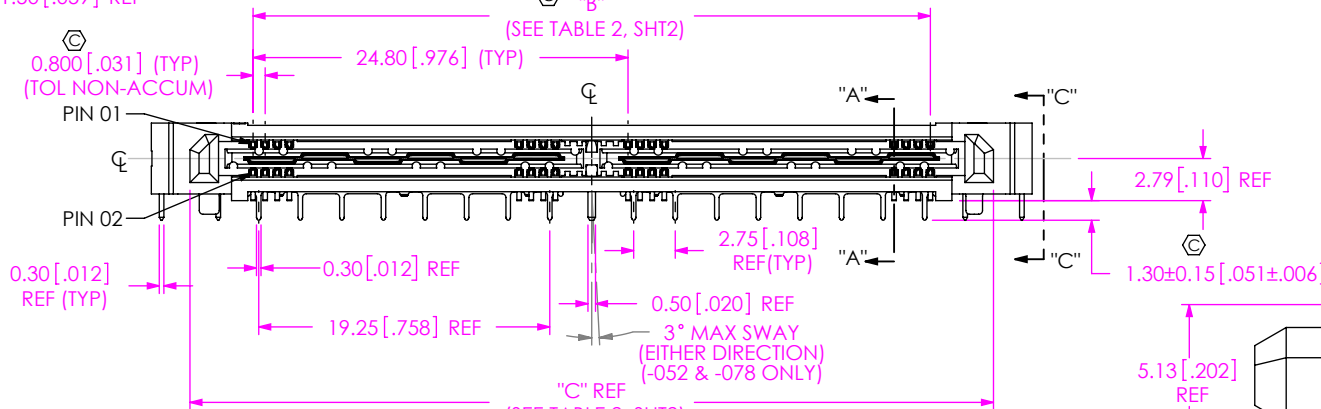
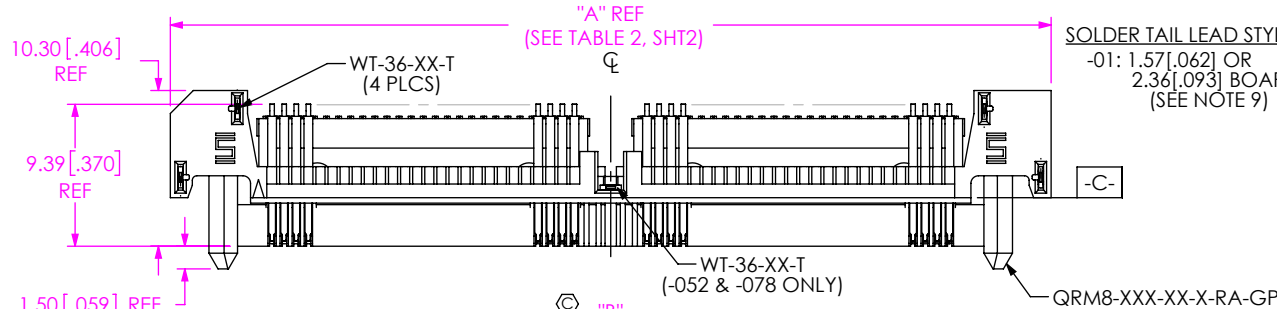

LEAD STYLE	"OVER MOLDED GROUND PLANE"	"WELD TAB"
-01	IM-T-1G35-01-X	WT-36-01-T

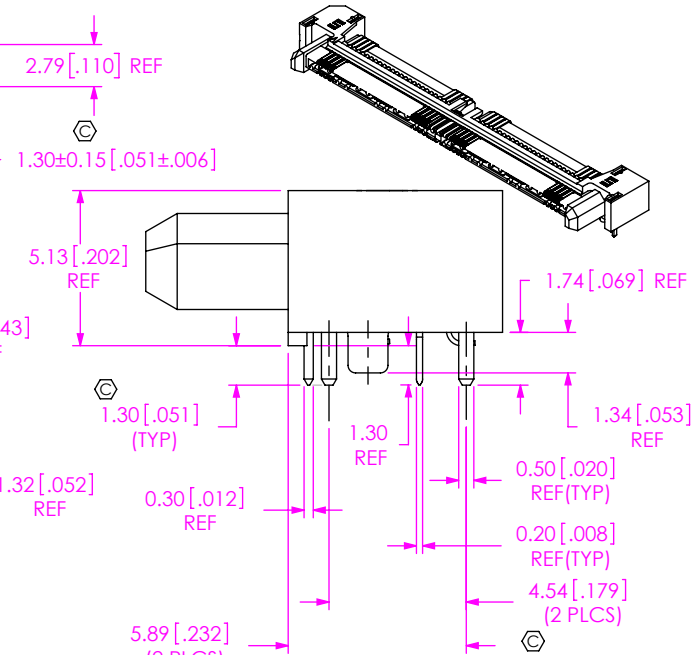
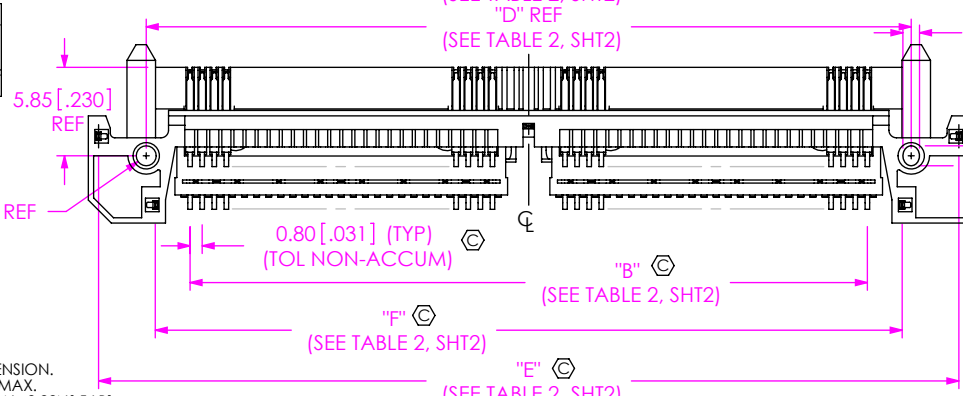

SECTION "C"- "C"
SCALE 4 : 1

NOTES:
1. Ⓞ REPRESENTS A CRITICAL DIMENSION.
2. BURR ALLOWANCE: 0.038[.0015] MAX.
3. MINIMUM PUSHOUT FORCE: SIGNAL: 2.22N[.5 LB].
GROUND PLANE: 4.45N[1 LB].
4. MEASURE AT BEND TANGENCY.
5. MEASURE ON PINS ONLY, STANDOFFS NOT INCLUDED
IN MEASUREMENT.
6. POST HEIGHT VARIATION BETWEEN ANY TWO PINS: 0.05[.002] MAXIMUM.
7. NOTE DELETED.
8. NOTE DELETED.
9. THE -01 SOLDER TAIL LEAD STYLE CAN BE USED FOR A 1.57[.062] OR A 2.36[.093]
THICK PCB IF SAMTEC'S RECOMMENDED STENCIL APERTURE IS UTILIZED.
10. DIMENSIONS MUST BE MEASURED BOTH ENDS OF COMB OR CONNECTOR.
11. NOTE DELETED.
12. NOTE DELETED.
13. NOTE DELETED.
14. NOTE DELETED.
15. SHEAR BURR ALLOWANCE: .15 [.006] MAX ON THIS EDGE.
16. TRAY IS STANDARD PACKAGING.
17. ORDERS WILL BE PACKAGED ACCORDING TO THE SAMTEC PACKAGING
EFFICIENCY STANDARDS (SPES) FOUND ON WWW.SAMTEC.COM.
18. ATTACH LABEL TO EACH REEL.

F:\DWG\MISC\WMTG\QRM8-XXX-XX-X-RA-GP-X-XX-MKT.SLDRW

UNLESS OTHERWISE SPECIFIED,
DIMENSIONS ARE IN
MILLIMETERS [INCHES].
TOLERANCES ARE:
DECIMALS ANGLES
X.X: ±0.3 [.01] 2°
X.XX: ±0.13 [.005]
X.XXX: ±0.050 [.0020]

PROPRIETARY NOTE
THIS DOCUMENT CONTAINS CONFIDENTIAL AND
PROPRIETARY INFORMATION AND ALL DESIGN,
MANUFACTURING, REPRODUCTION, USE, PATENT RIGHTS
AND SALES RIGHTS ARE EXPRESSLY RESERVED BY SAMTEC,
INC. THIS DOCUMENT SHALL NOT BE DISCLOSED, IN WHOLE
OR PART, TO ANY UNAUTHORIZED PERSON OR ENTITY NOR
REPRODUCED, TRANSFERRED OR INCORPORATED IN ANY
OTHER PROJECT IN ANY MANNER WITHOUT THE EXPRESS
WRITTEN CONSENT OF SAMTEC, INC.

MATERIAL: DO NOT SCALE DRAWING SHEET SCALE: 2:1
INSULATORS: LCP UL94V-0; COLOR: BLACK
CONTACT: PHOS BRONZE
GROUND PLANE: PHOS BRONZE



520 PARK EAST BLVD, NEW ALBANY, IN 47150
PHONE: 812-944-6733 FAX: 812-948-5047
e-Mail info@SAMTEC.com code 55322

DESCRIPTION:
0.8mm Q-RATE RIGHT ANGLE TERMINAL ASSEMBLY
DWG. NO.
QRM8-XXX-XX-X-RA-GP-X-XX
BY: R MUSSER 10/02/2008 SHEET 1 OF 6

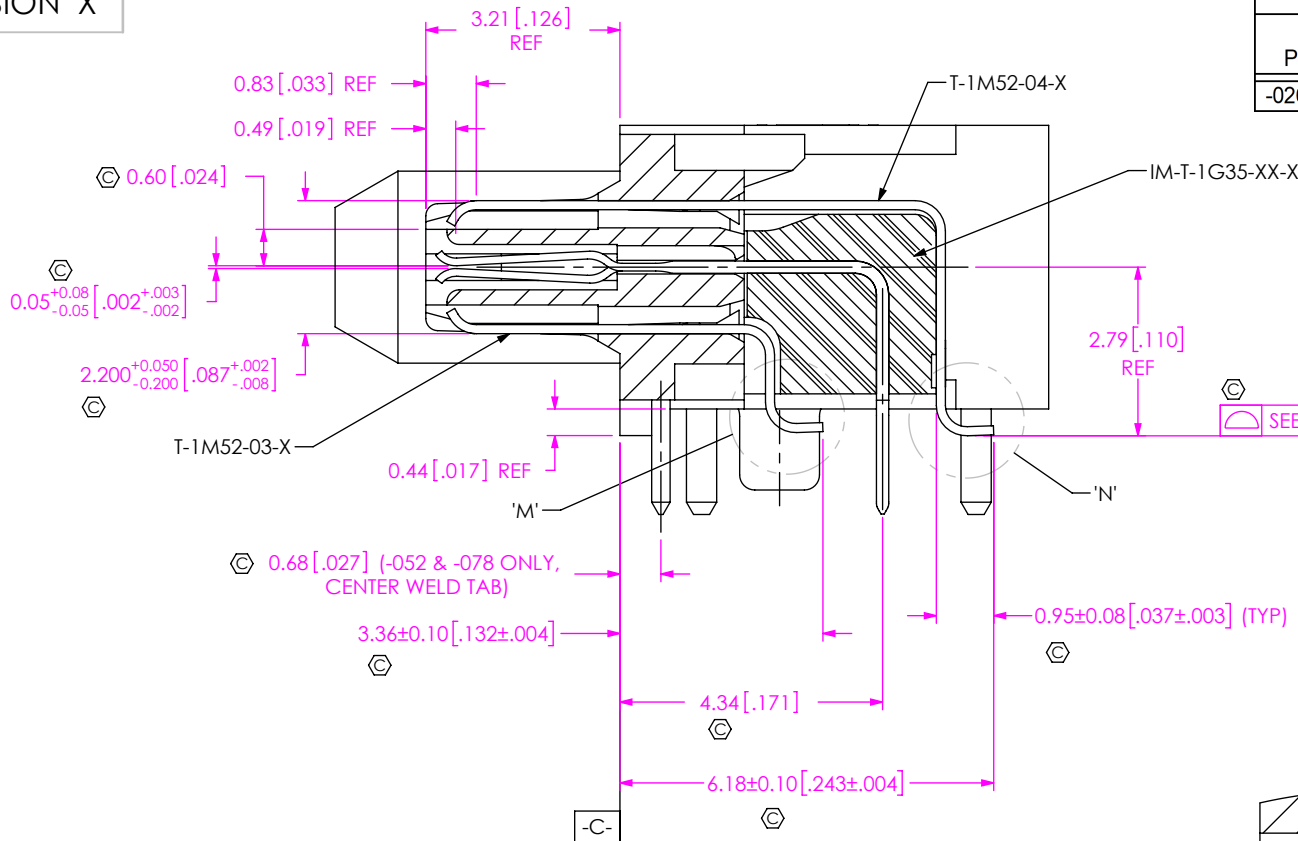

No OF POSITIONS	BOTTOM ROW STRAIGHTNESS	TOP ROW STRAIGHTNESS	COPLANARITY
-026, -052, -078	0.10 [0.004]	0.10 [0.004]	0.15 [0.006]

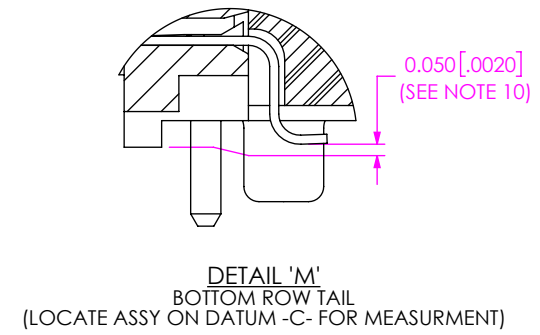

SECTION "A"- "A"
SCALE 8 : 1

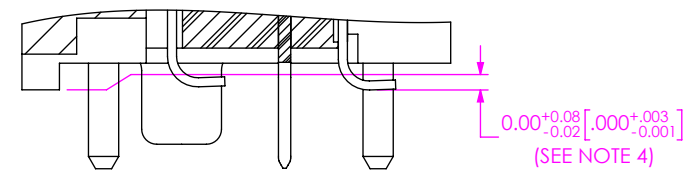

No OF POSITIONS	"A"	"B"	"C"	"D"	"E"	"F"
-026	33.46 [1.317]	20.00 [0.787]	28.35 [1.116]	25.80 [1.016]	32.11 [1.264]	24.61 [0.969]
-052	58.26 [2.294]	44.80 [1.764]	53.15 [2.093]	50.60 [1.992]	56.91 [2.240]	49.41 [1.945]
-078	83.06 [3.270]	69.60 [2.740]	77.95 [3.069]	75.40 [2.969]	81.71 [3.217]	74.21 [2.921]

PROPRIETARY NOTE
THIS DOCUMENT CONTAINS CONFIDENTIAL AND PROPRIETARY INFORMATION AND ALL DESIGN, MANUFACTURING, REPRODUCTION, USE, PATENT RIGHTS AND SALES RIGHTS ARE EXPRESSLY RESERVED BY SAMTEC, INC. THIS DOCUMENT SHALL NOT BE DISCLOSED, IN WHOLE OR PART, TO ANY UNAUTHORIZED PERSON OR ENTITY NOR REPRODUCED, TRANSFERRED OR INCORPORATED IN ANY OTHER PROJECT IN ANY MANNER WITHOUT THE EXPRESS WRITTEN CONSENT OF SAMTEC, INC.



520 PARK EAST BLVD, NEW ALBANY, IN 47150
PHONE: 812-944-6733 FAX: 812-948-5047
e-Mail info@SAMTEC.com code 55322

DO NOT SCALE DRAWING
SHEET SCALE: 2:1

DESCRIPTION:
0.8mm Q-RATE RIGHT ANGLE TERMINAL ASSEMBLY

DWG. NO.
QRM8-XXX-XX-X-RA-GP-X-XX

BY: R MUSSER 10/02/2008 SHEET 2 OF 6

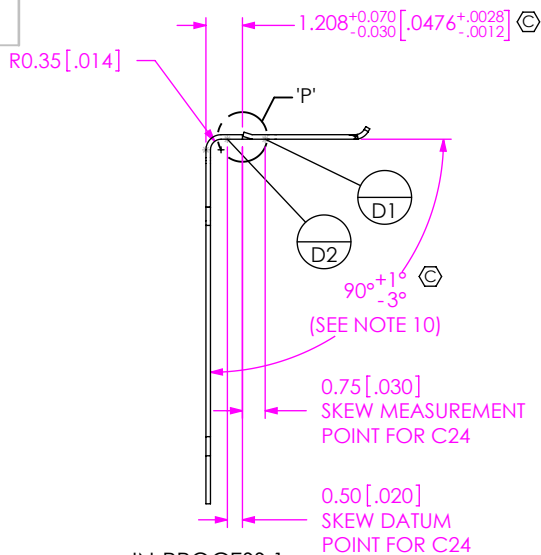

IN-PROCESS 1
(FORM 1 CONTACT T-1M52-03-X)
(RIGHT SIDE SHOWN)

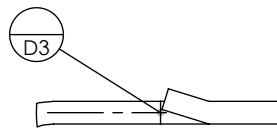

DETAIL 'P'
SCALE 20 : 1

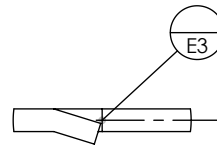

DETAIL 'Q'
SCALE 20 : 1

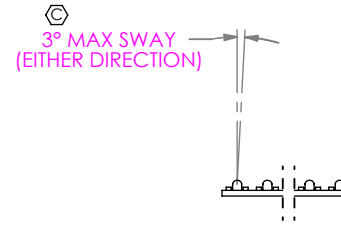

T-1M52-XX-X IN-PROCESS VIEW

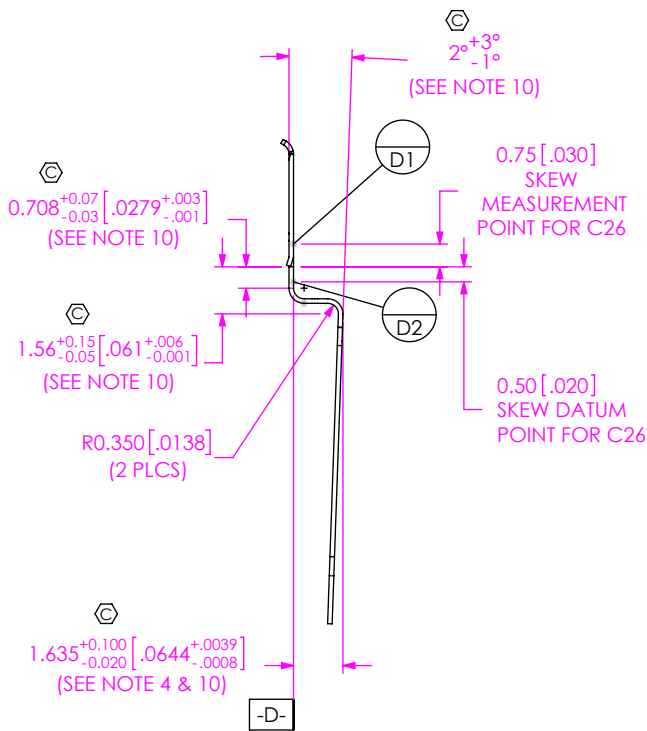
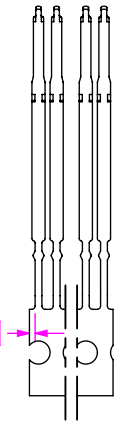

IN-PROCESS 2
(FORM 2 CONTACT T-1M52-03-X)
(RIGHT SIDE SHOWN)

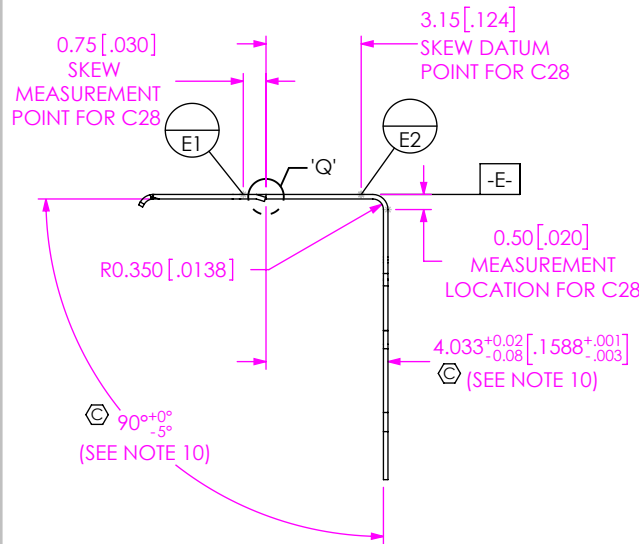

IN-PROCESS 6
(FORM 1 CONTACT T-1M52-04-X)
(LEFT SIDE SHOWN)

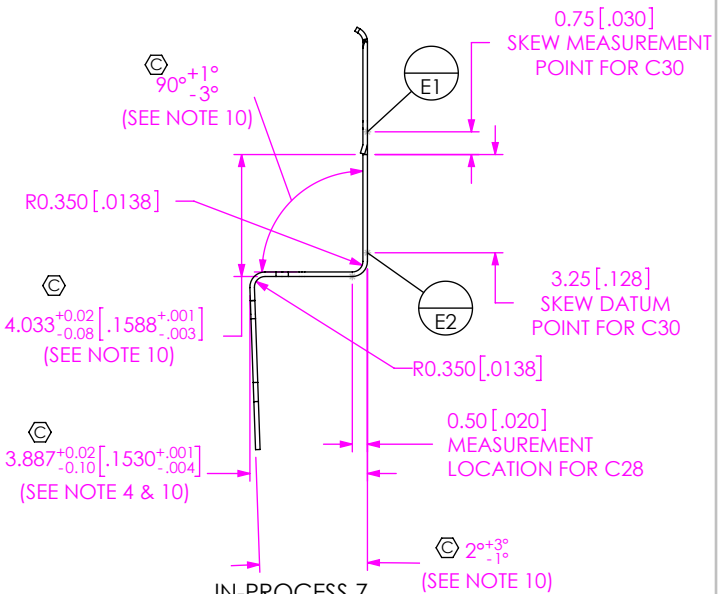

IN-PROCESS 7
(FORM 2 CONTACT T-1M52-04-X)
(LEFT SIDE SHOWN)

PROPRIETARY NOTE
THIS DOCUMENT CONTAINS CONFIDENTIAL AND PROPRIETARY INFORMATION AND ALL DESIGN, MANUFACTURING, REPRODUCTION, USE, PATENT RIGHTS AND SALES RIGHTS ARE EXPRESSLY RESERVED BY SAMTEC, INC. THIS DOCUMENT SHALL NOT BE DISCLOSED, IN WHOLE OR PART, TO ANY UNAUTHORIZED PERSON OR ENTITY NOR REPRODUCED, TRANSFERRED OR INCORPORATED IN ANY OTHER PROJECT IN ANY MANNER WITHOUT THE EXPRESS WRITTEN CONSENT OF SAMTEC, INC.



520 PARK EAST BLVD, NEW ALBANY, IN 47150
PHONE: 812-944-6733 FAX: 812-948-5047
e-Mail info@SAMTEC.com code 55322

DO NOT SCALE DRAWING

SHEET SCALE: 4:1

DESCRIPTION:
0.8mm Q-RATE RIGHT ANGLE TERMINAL ASSEMBLY

DWG. NO.
QRM8-XXX-XX-X-RA-GP-X-XX

BY: R MUSSER 10/02/2008 SHEET 3 OF 6

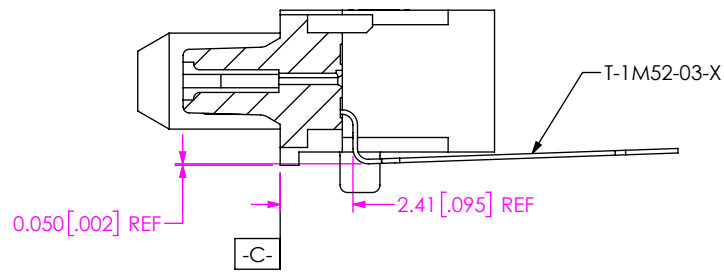

IN-PROCESS 3
(FILL BOTTOM ROW)
(SEE INSPECTION VIEW 1 FOR ASSEMBLY ORIENTATION AND CPC'S)

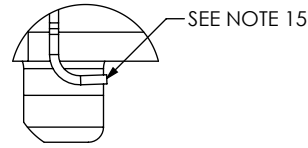

DETAIL 'R'
SCALE 8 : 1

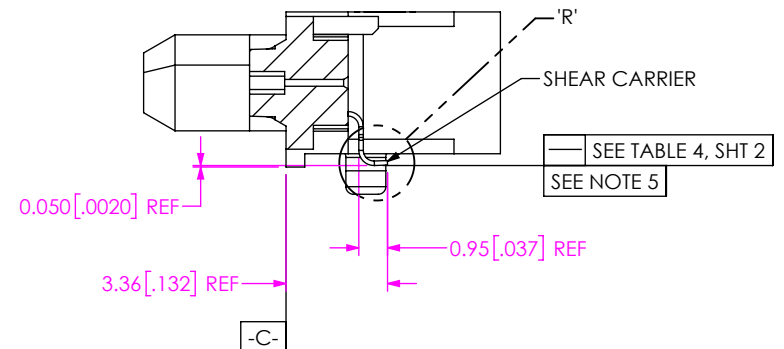

IN-PROCESS 4
(CUTOFF OF CARRIER)
(SEE INSPECTION VIEW 1 FOR ASSEMBLY ORIENTATION AND CPC'S)

INSPECTION VIEW 1

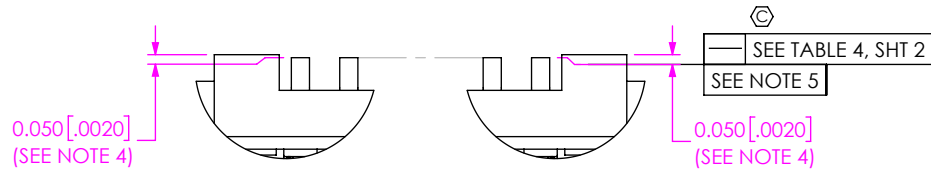
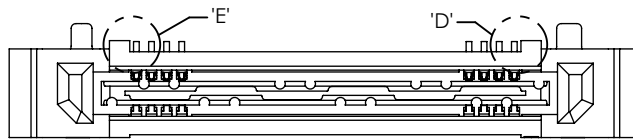

DETAIL 'E'
SCALE 8 : 1

DETAIL 'D'
SCALE 8 : 1

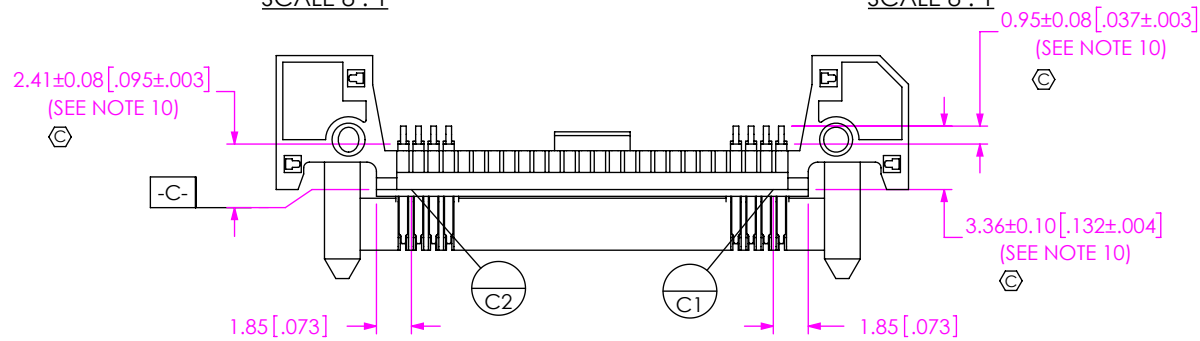

INSPECTION FOR IN-PROCESS 3 & 4
(CARRIER NOT SHOWN FOR IN PROCESS 3 INSPECTIONS)

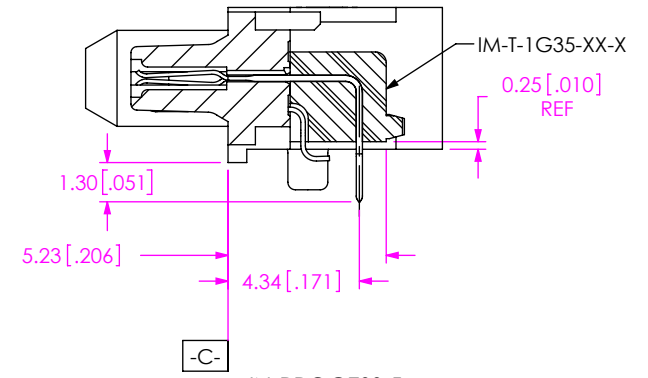

IN-PROCESS 5
(FILL OVER MOLDED GROUND PLANE)
(IM-T-1G35-XX-X)

PROPRIETARY NOTE
THIS DOCUMENT CONTAINS CONFIDENTIAL AND PROPRIETARY INFORMATION AND ALL DESIGN, MANUFACTURING, REPRODUCTION, USE, PATENT RIGHTS AND SALES RIGHTS ARE EXPRESSLY RESERVED BY SAMTEC, INC. THIS DOCUMENT SHALL NOT BE DISCLOSED, IN WHOLE OR PART, TO ANY UNAUTHORIZED PERSON OR ENTITY NOR REPRODUCED, TRANSFERRED OR INCORPORATED IN ANY OTHER PROJECT IN ANY MANNER WITHOUT THE EXPRESS WRITTEN CONSENT OF SAMTEC, INC.



520 PARK EAST BLVD, NEW ALBANY, IN 47150
PHONE: 812-944-6733 FAX: 812-948-5047
e-Mail info@SAMTEC.com code 55322

DO NOT SCALE DRAWING

SHEET SCALE: 4:1

DESCRIPTION:
0.8mm Q-RATE RIGHT ANGLE TERMINAL ASSEMBLY

DWG. NO.
QRM8-XXX-XX-X-RA-GP-X-XX

BY: R MUSSER 10/02/2008 SHEET 4 OF 6

REVISION X

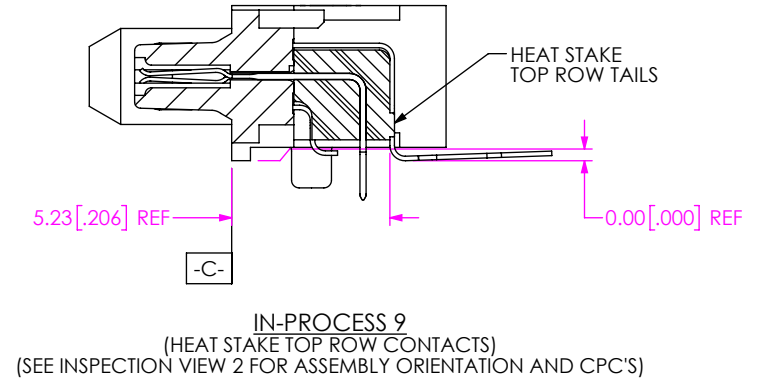
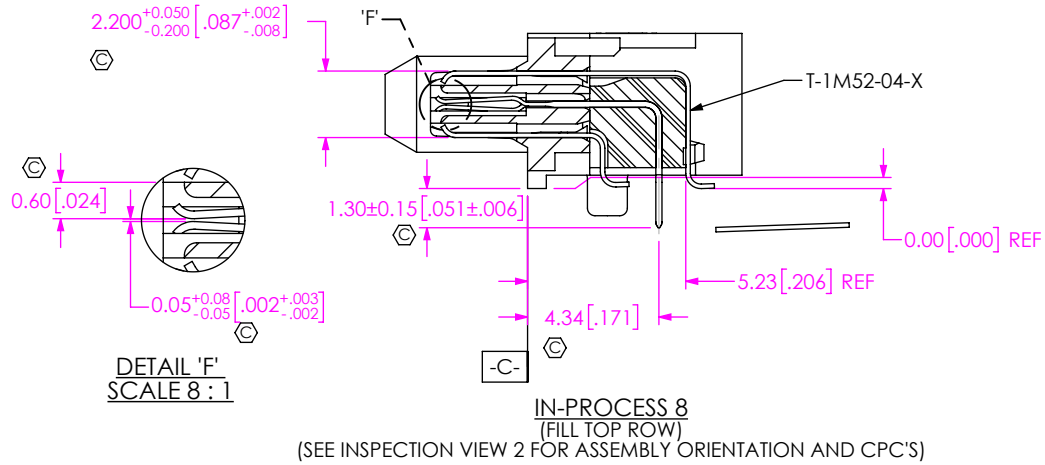

INSPECTION VIEW 2

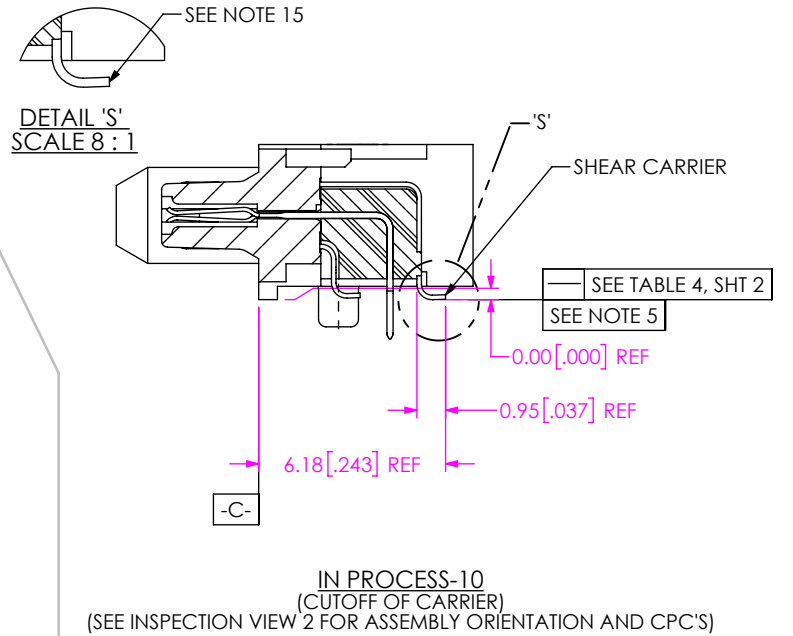
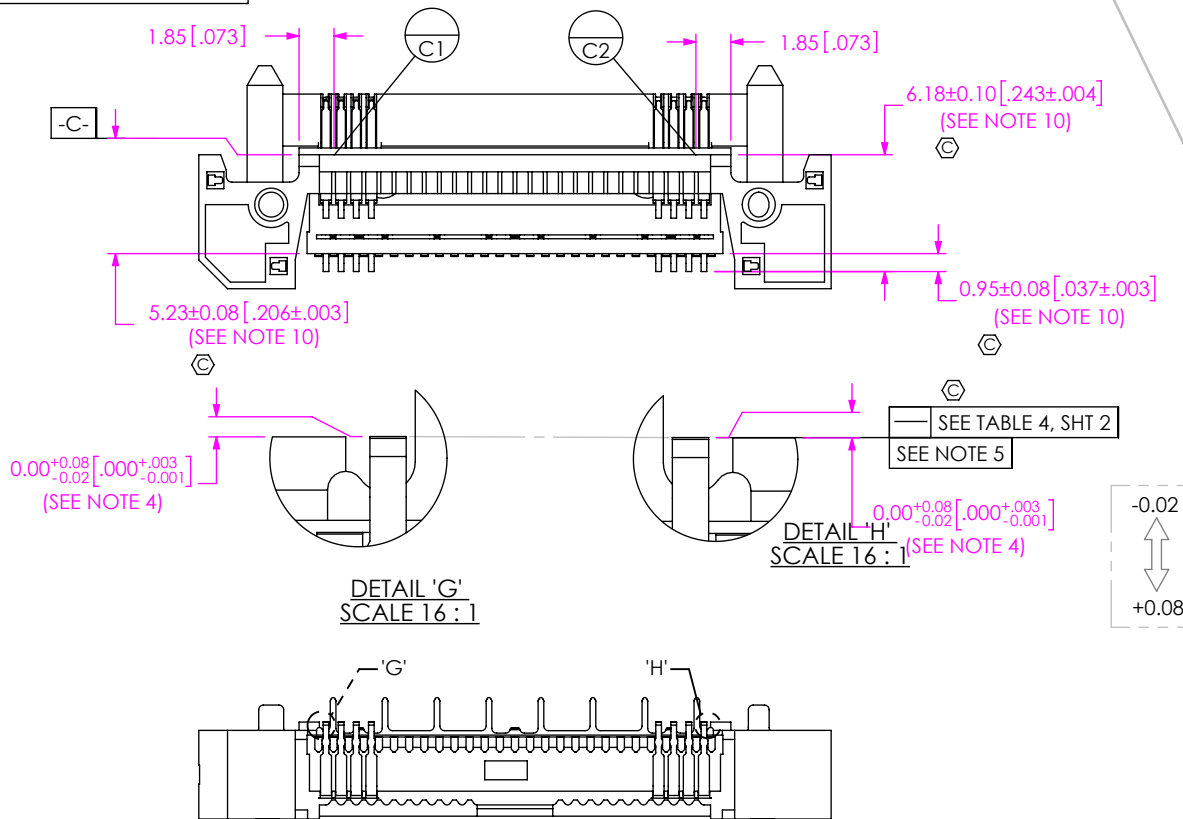

INSPECTION FOR IN-PROCESS 8, 9 & 10
 (CARRIER NOT SHOWN FOR IN-PROCESS 8 INSPECTIONS)

PROPRIETARY NOTE
 THIS DOCUMENT CONTAINS CONFIDENTIAL AND PROPRIETARY INFORMATION AND ALL DESIGN, MANUFACTURING, REPRODUCTION, USE, PATENT RIGHTS AND SALES RIGHTS ARE EXPRESSLY RESERVED BY SAMTEC, INC. THIS DOCUMENT SHALL NOT BE DISCLOSED, IN WHOLE OR PART, TO ANY UNAUTHORIZED PERSON OR ENTITY NOR REPRODUCED, TRANSFERRED OR INCORPORATED IN ANY OTHER PROJECT IN ANY MANNER WITHOUT THE EXPRESS WRITTEN CONSENT OF SAMTEC, INC.

samtec
 520 PARK EAST BLVD, NEW ALBANY, IN 47150
 PHONE: 812-944-6733 FAX: 812-948-5047
 e-Mail info@SAMTEC.com code 55322

DO NOT SCALE DRAWING
 SHEET SCALE: 4:1

DESCRIPTION:
 0.8mm Q-RATE RIGHT ANGLE TERMINAL ASSEMBLY
 DWG. NO.
QRM8-XXX-XX-X-RA-GP-X-XX
 BY: R MUSSER 10/02/2008 SHEET 5 OF 6

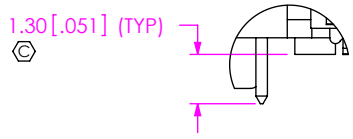
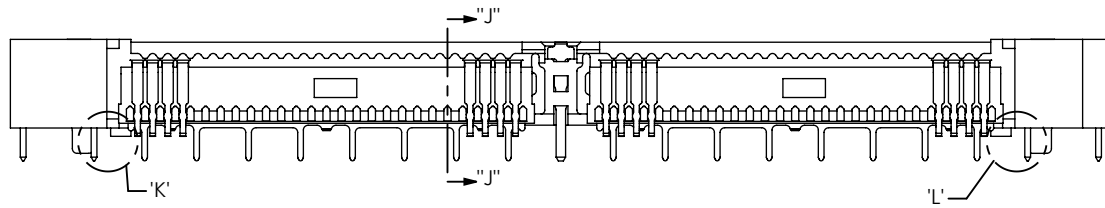

DETAIL 'K'
SCALE 5:1

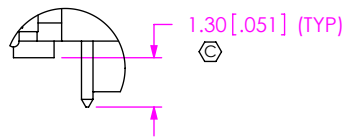

DETAIL 'L'
SCALE 5:1

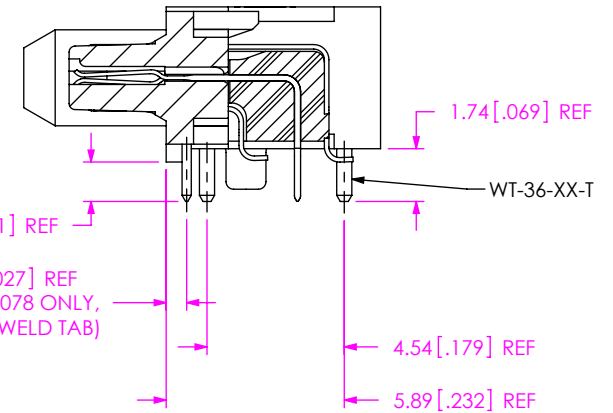

SECTION "J"-"J"

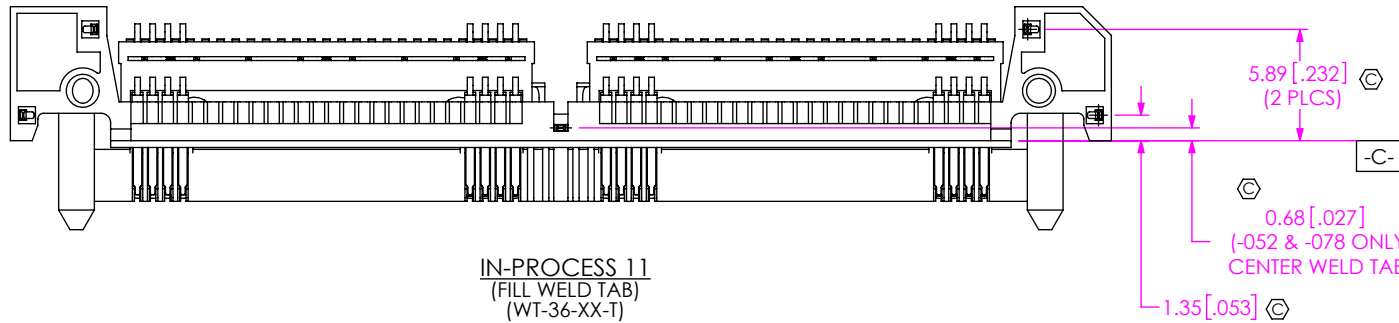

IN-PROCESS 11
(FILL WELD TAB)
(WT-36-XX-T)

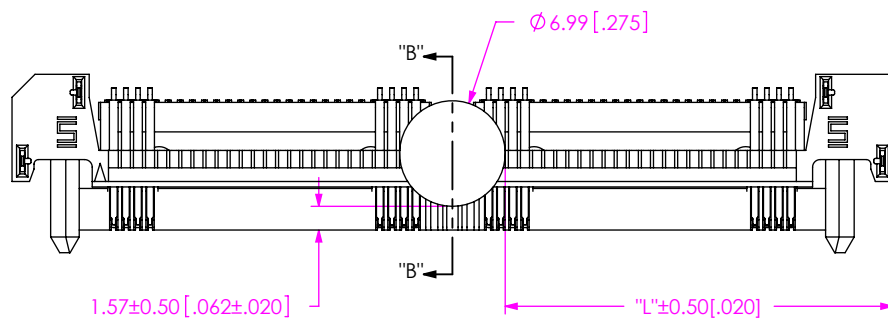
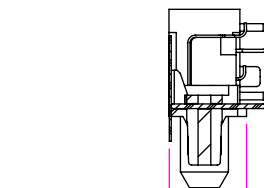

FIG 2
-K OPTION
(USE K-DOT-.276-.375-.005)
(QRM8-052-01-X-RA-GP-K SHOWN)
(SOME DETAIL REMOVED FOR CLARITY)

SECTION "B"-"B"
SCALE 2:1



No OF POSITIONS	"L"
-026	13.24 [0.521]
-052	25.64 [1.009]
-078	38.04 [1.498]

PROPRIETARY NOTE
THIS DOCUMENT CONTAINS CONFIDENTIAL AND PROPRIETARY INFORMATION AND ALL DESIGN, MANUFACTURING, REPRODUCTION, USE, PATENT RIGHTS AND SALES RIGHTS ARE EXPRESSLY RESERVED BY SAMTEC, INC. THIS DOCUMENT SHALL NOT BE DISCLOSED, IN WHOLE OR PART, TO ANY UNAUTHORIZED PERSON OR ENTITY NOR REPRODUCED, TRANSFERRED OR INCORPORATED IN ANY OTHER PROJECT IN ANY MANNER WITHOUT THE EXPRESS WRITTEN CONSENT OF SAMTEC, INC.



520 PARK EAST BLVD, NEW ALBANY, IN 47150
PHONE: 812-944-6733 FAX: 812-948-5047
e-Mail info@SAMTEC.com code 55322

DO NOT SCALE DRAWING

SHEET SCALE: 4:1

DESCRIPTION:
0.8mm Q-RATE RIGHT ANGLE TERMINAL ASSEMBLY

DWG. NO.
QRM8-XXX-XX-X-RA-GP-X-XX

BY: R MUSSER 10/02/2008 SHEET 6 OF 6