

P. C. B LAYOUT

SPECIFICATIONS

Current Rating: 3Amps
 Insulator resistance: 5000 Megohms min.
 Dielectric Withstaanding: AC 500V
 Operating Temperature: -40° C to +105° C
 Insulator Material: PBT
 Plating: Gold flash
 Color: Black

UNSPECIFIED TOLERANCE: ±0.20

Dimensions list

| Contacts Per row | Dimensions | | Contacts Per row | Dimensions | |
|------------------|------------|-------|------------------|------------|-------|
| | A | B | | A | B |
| 6 | 5.08 | 15.22 | 30 | 35.56 | 45.7 |
| 8 | 7.62 | 17.76 | 32 | 38.1 | 48.24 |
| 10 | 10.16 | 20.3 | 34 | 40.64 | 50.78 |
| 12 | 12.7 | 22.84 | 36 | 43.18 | 53.32 |
| 14 | 15.24 | 25.38 | 38 | 45.72 | 55.86 |
| 16 | 17.78 | 27.92 | 40 | 48.26 | 58.4 |
| 18 | 20.32 | 30.46 | 42 | 50.8 | 60.94 |
| 20 | 22.86 | 33 | 44 | 53.34 | 63.48 |
| 22 | 25.4 | 35.54 | 46 | 55.88 | 66 |
| 24 | 27.94 | 38.08 | 48 | 58.42 | 68.56 |
| 26 | 30.48 | 40.62 | 50 | 60.96 | 71.1 |
| 28 | 33.02 | 43.16 | | | |

深圳市金航标电子有限公司

www.kinghelm.com.cn

PH2.54*8.9 180度 筒牛

KH-2.54PH180-2X9P-L8.9

0755-28190160

Customer:

Approval:

Unit

Scale

Date

Drawing:

Check:

mm

05.03.05

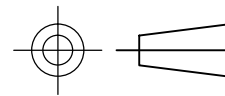

P/NO:

Pin Longer:

Signatuer: