

PART NUMBER  
10148426-10xLF

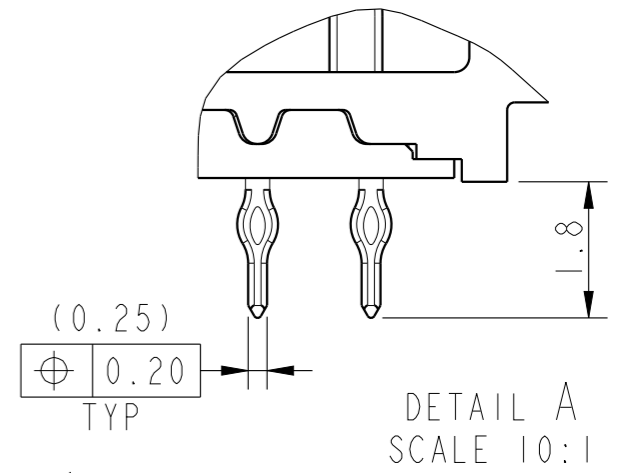
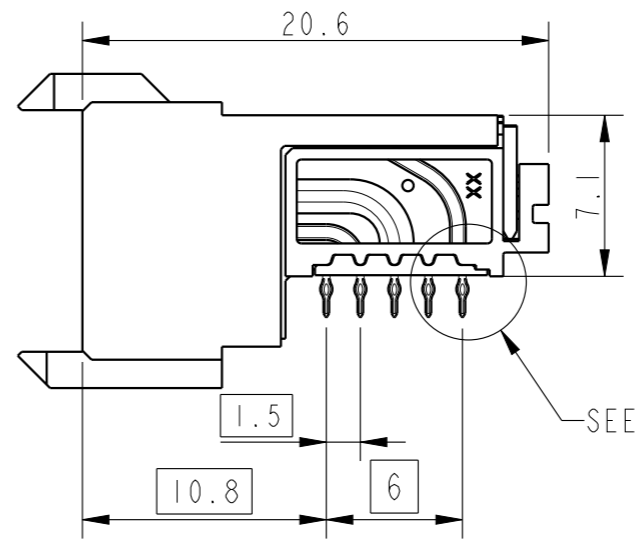
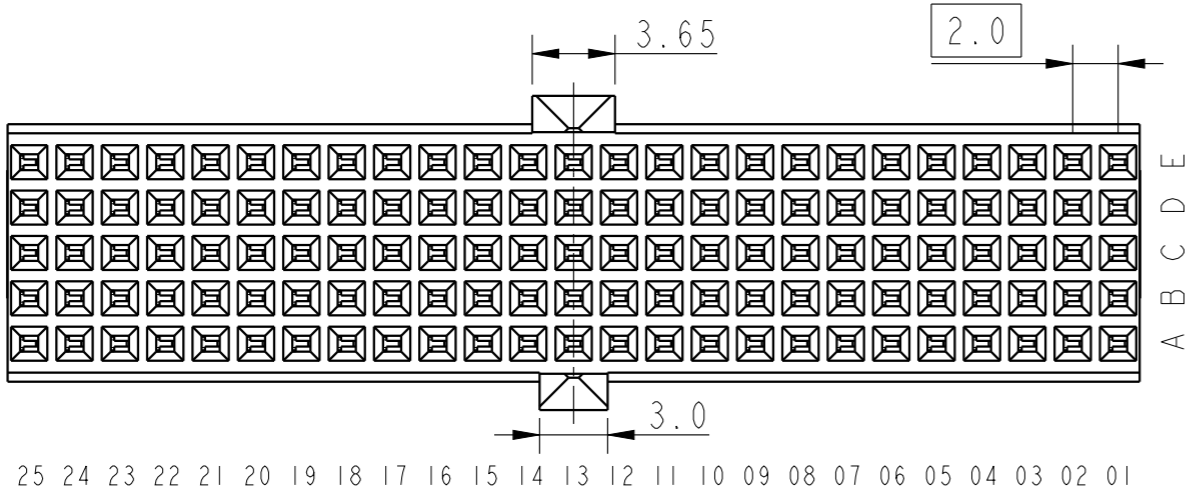
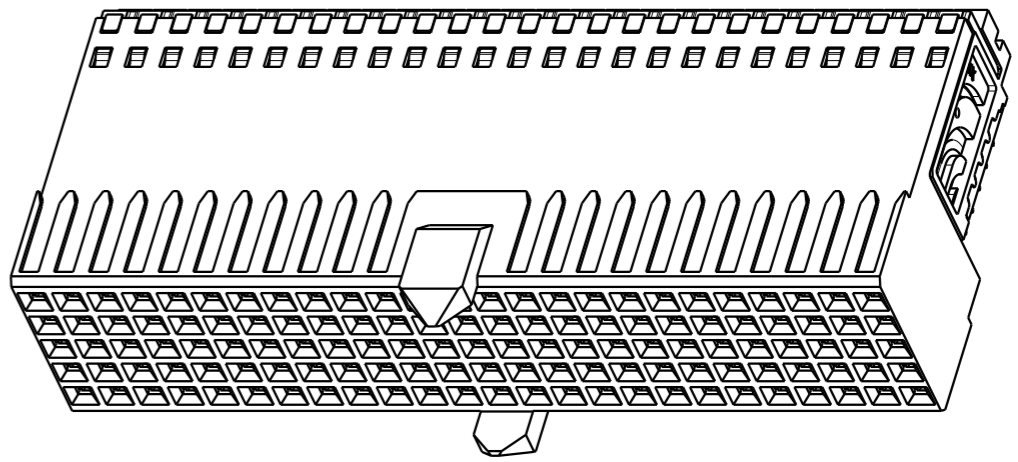
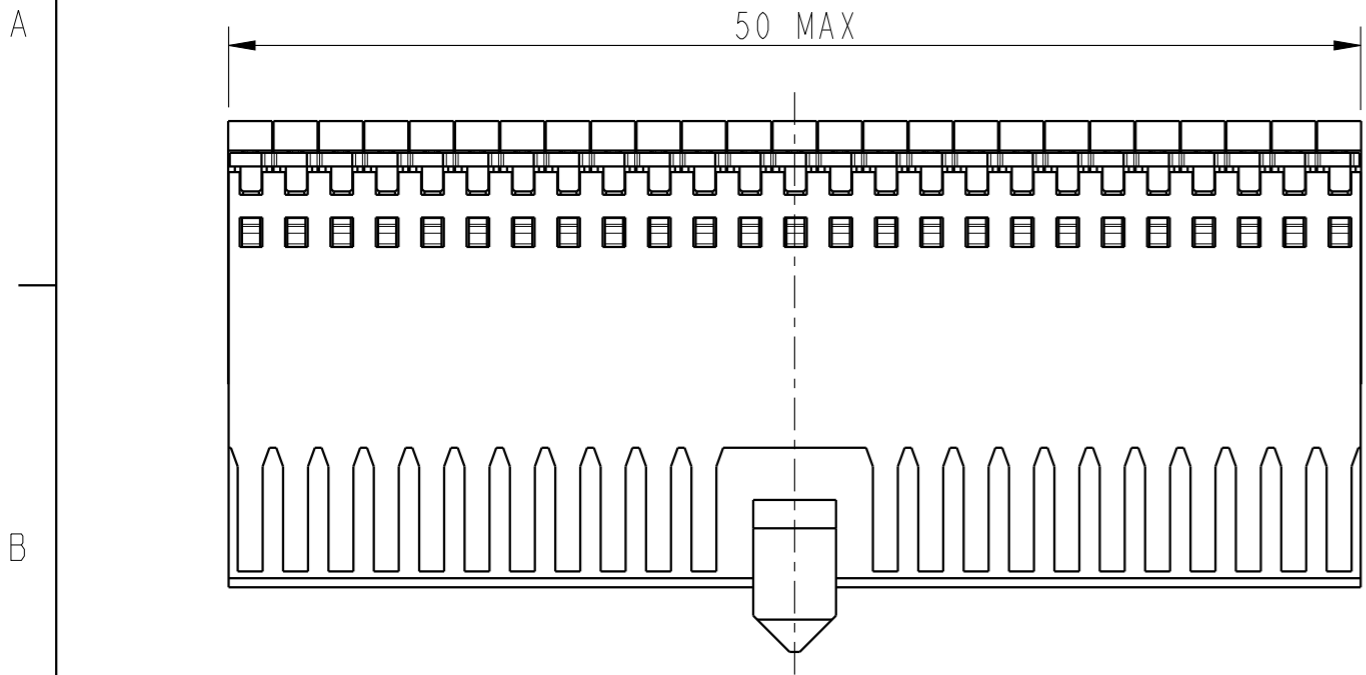

Amphenol  
FCi

© 2016 AFCI

spec ref		dr	Binesh C	2018/08/04	projection	MM	size	A3	scale	1:1	
tolerance std		eng	Binesh C	2018/08/04			ecn no		-		
ISO 406 ISO 1101		TOLERANCES UNLESS OTHERWISE SPECIFIED		product family			MILLIPACS		rel level		Released
surface	linear	0.X	±0.3			MILLIPACS HS RA RECEPTACLE TYPE AB		dwg no 10148426	rev		A
		0.XX	±0.20			VERTICAL PINNING_WITHOUT TOP SHIELD			-		-
ISO 1302	angular	0°	±3°		cat. no.	10148426-10xLF	Product - Customer Drw		sheet 1 of 3		

PINNING CONFIGURATION : 10148426-101LF

Z	0	0	0	0	0	0	0	0	0	0				0	0	0	0	0	0	0	0	0	0
A	HS	G	HS	G	HS	G	HS	G	HS	G	HS	G	HS	G	HS	G	HS	G	HS	G	HS	G	HS
B	HS	G	HS	G	HS	G	HS	G	HS	G	HS	G	HS	G	HS	G	HS	G	HS	G	HS	G	HS
C	G	G	G	G	G	G	G	G	G	G	G	G	G	G	G	G	G	G	G	G	G	G	G
D	HS	G	HS	G	HS	G	HS	G	HS	G	HS	G	HS	G	HS	G	HS	G	HS	G	HS	G	HS
E	HS	G	HS	G	HS	G	HS	G	HS	G	HS	G	HS	G	HS	G	HS	G	HS	G	HS	G	HS
F	0	0	0	0	0	0	0	0	0	0				0	0	0	0	0	0	0	0	0	0

HS	HIGH SPEED SIGNAL
G	GROUND
0	EMPTY

PINNING CONFIGURATION : 10148426-102LF

Z	0	0	0	0	0	0	0	0	0	0				0	0	0	0	0	0	0	0	0	0
A	HS	G	HS	G	HS	G	HS	G	HS	G	HS	G	HS	G	HS	G	HS	G	HS	G	HS	G	HS
B	HS	G	HS	G	HS	G	HS	G	HS	G	HS	G	HS	G	HS	G	HS	G	HS	G	HS	G	HS
C	LS	G	LS	G	LS	G	LS	G	LS	G	LS	G	LS	G	LS	G	LS	G	LS	G	LS	G	LS
D	HS	G	HS	G	HS	G	HS	G	HS	G	HS	G	HS	G	HS	G	HS	G	HS	G	HS	G	HS
E	HS	G	HS	G	HS	G	HS	G	HS	G	HS	G	HS	G	HS	G	HS	G	HS	G	HS	G	HS
F	0	0	0	0	0	0	0	0	0	0				0	0	0	0	0	0	0	0	0	0

HS	HIGH SPEED SIGNAL
LS	LOW SPEED SIGNAL
G	GROUND
0	EMPTY

Amphenol FCI

© 2016 AFCI

spec ref	dr	Binesh C	2018/08/04	projection	MM	size	A3	scale	1:1
tolerance std	eng	Binesh C	2018/08/04			ecn no		-	
ISO 406 ISO 1101	chr	-	-			rel level		Released	
surface	linear	0.X	±0.3		MILLIPACS HS RA RECEPTACLE TYPE AB VERTICAL PINNING_WITHOUT TOP SHIELD	cat. no. 10148426-10xLF	Product - Customer Drw	sheet 2 of 3	rev A
		0.XX	±0.20						
		0.XXX	±0.15						
ISO 1302	angular	0°	±3°	MILLIPACS		10148426		A	

PART NUMBER  
10148426-10xLF

RECOMMENDED PCB LAYOUT

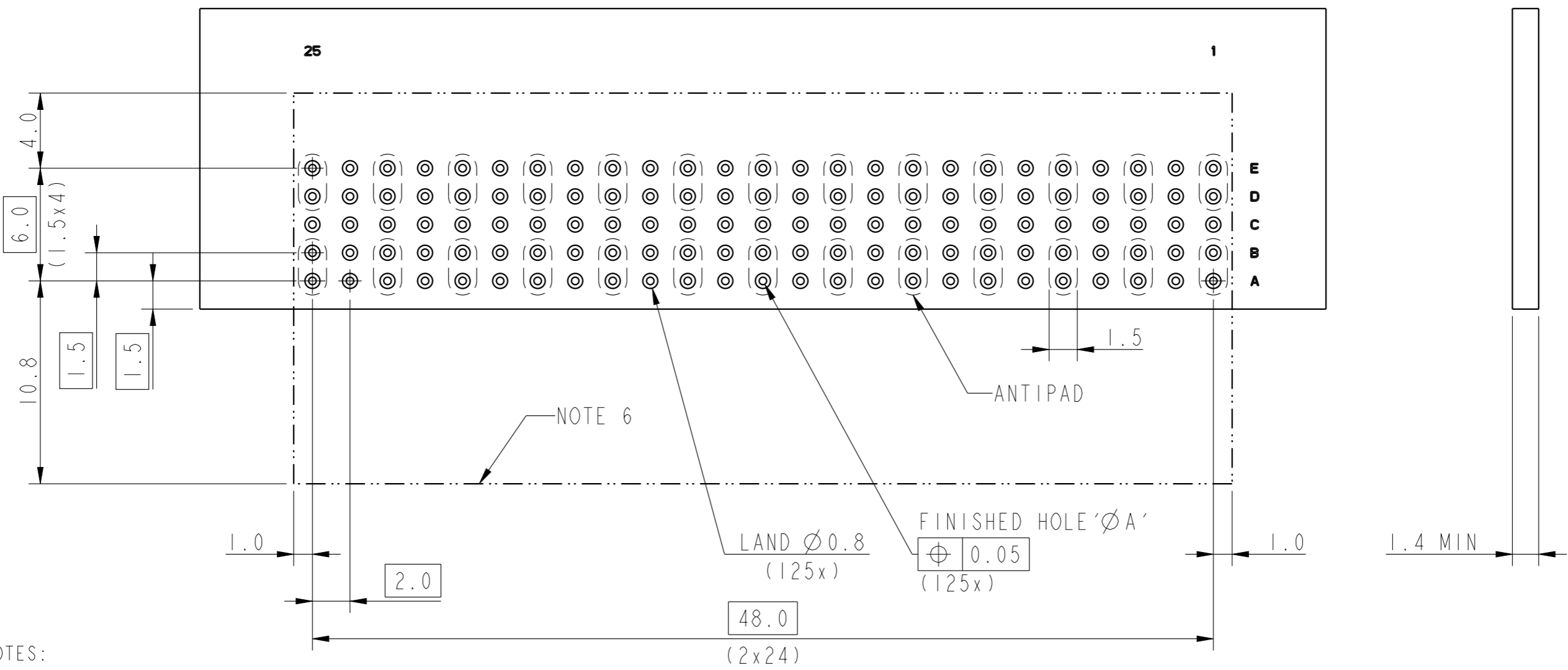

NOTES:

1. Materials
  - Housing & IMLA's: LCP (UL94 V-0)
  - Leadframe: Copper alloy
2. Finish
  - Contact area: Ni underlayer with GXT top layer
  - EON area: Ni underlayer with Sn top layer
3. Mates with IEC 61076-4-101 series 2mm HM headers with contact mating level 1 & 2 in signal rows.
4. Mounting style: Press-fit, flat rock insertion
5. Refer the table for Recommended plated through hole dimensions.
6. Connector spacing

RECOMMENDED PLATED THROUGH HOLE DIMENSIONS

DIM	FINISHED HOLE DIA	Cu. THICKNESS	Sn THICKNESS	DRILLED HOLE DIA
A	0.35-0.45	0.02-0.05	0.0008-0.0012	0.45-0.49

Amphenol  
FCi

© 2016 AFCI

spec ref	dr	Binesh C	2018/08/04	projection	MM	size	A3	scale	1:1
tolerance std	eng	Binesh C	2018/08/04			ecn no			
ISO 406 ISO 1101	chr	-	-			-			
surface	linear	0.X	±0.3		product family MILLIPACS	rel level			
		0.XX	±0.20			Released			
ISO 1302	angular	0°	±3°	MILLIPACS HS RA RECEPTACLE TYPE AB VERTICAL PINNING_WITHOUT TOP SHIELD		10148426		rev A	
cat. no.		10148426-10xLF		Product - Customer Drw			sheet 3 of 3		