





-  Meets IEEE 802.3 & ANSI X3.263 Standards.
-  Designed For 1000 BASE-T Applications, Surface Mount Type.
-  Operating Temperature Range: -40°C to +85°C.
-  RoHS Compliant.



Electrical Specifications @25°C

Part Number	Turns Ratio (±5%)	OCL(uH Min) @100KHz,0.1V With 8mA DC Bias	CWW(pF Max) @100KHz,0.1V	DCR (Ω Max)	Insertion Loss (dB Max)	Return Loss (dB Min)		HI-POT (Vrms)
					0.5-150MHz	0.5-40MHz	40.1-100MHz	
CL4532A-201	1CT:1CT	200	35	2.5	-2.0	-18	-12+20*log(f/80)	1500

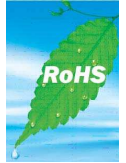
MECHANICAL

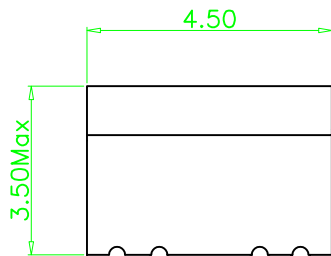

FRONT VIEW

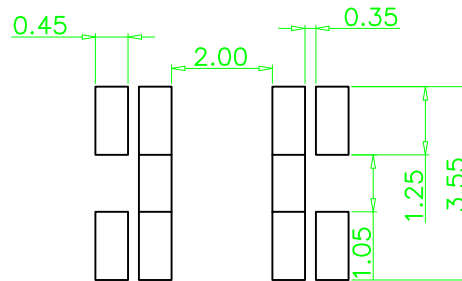

SUGGESTED PAD LAYOUT

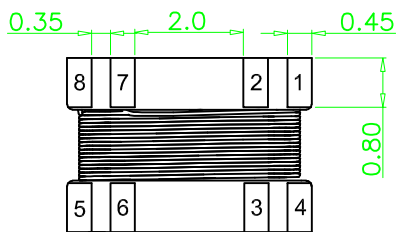

BOTTOM VIEW

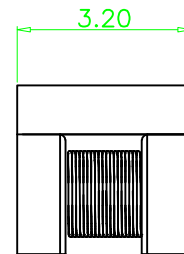

SIDE VIEW

Unless otherwise specified all tolerances are: ±0.25 in mm

SCHEMATICS

