

M12

1210 ... 3...

Cordsets M12



Actuator/sensor cordset with overmolded connector

**Cable end 1:**

M12 male, straight, A-coded, IP67

**Cable end 2:**

blunt cut

**Cable:**

PUR, black

---

Approvals:



M12

1210 ... 3...

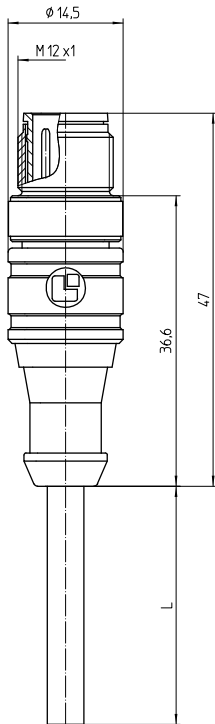

### Environmental conditions

Temperature range -25 °C/+80 °C

### Materials

Insulating body TPU GF, HB according to UL94  
 Contact pin CuZn, pre-nickel and gold-plated  
 Overmolding/handle TPU<sup>1</sup>  
 Knurled screw CuZn, nickel-plated

<sup>1</sup> material halogen-free

### Mechanical data

Mating cycles  $\geq 100$   
 Insertion force  $\leq 10$  N (4-5 poles)  
 $\leq 23$  N (8 poles)<sup>1</sup>  
 Withdrawal force  $\leq 15$  N (4-5 poles)  
 $\leq 30$  N (8 poles)<sup>1</sup>

Protection class IP67<sup>2</sup>

<sup>1</sup> measured with a proper counterpart

<sup>2</sup> according to IEC DIN EN 60529, only in locked condition with an appropriate counterpart

### Pin assignments for male M12 connectors, A-coded, front view

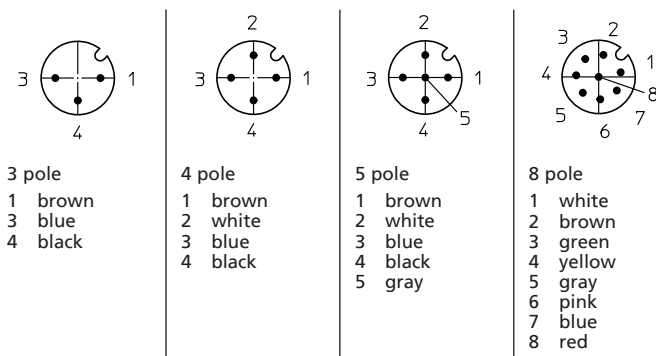

### Connected cable

Outer jacket PUR, black

### Electrical data (at T<sub>amb</sub> 20 °C)

Contact resistance  $\leq 10$  m $\Omega$   
 Rated current 4 A (3-5 poles)  
 2 A (8 poles)  
 1.5 A (12 poles)  
 (T<sub>amb</sub> 40 °C)  
 Rated voltage 250 V AC/DC (3-4 poles)  
 60 V AC/DC (5 poles)  
 30 V AC/DC (8-12 poles)  
 Rated impulse voltage 2500 V (3-4 poles)  
 1500 V (5 poles)  
 800 V (8-12 poles)  
 Material group I (IEC)/0 (UL) (CTI = 600)  
 Insulation resistance > 100 M $\Omega$

### Associated products

Counterparts  
 ☞ 1200 ... 0...      ☞ 1200 ... 3...      ☞ 1205 ... 0...  
 ☞ 1205 ... 3...      ☞ 1206 ... L1 0...      ☞ 1206 ... L1 3...  
 ☞ 1206 ... L2 0...      ☞ 1206 ... L2 3...      ☞ 1210 1200 ... 0...  
 ☞ 1210 1200 ... 3...      ☞ 1210 1205 ... 3...      ☞ 1210 1206 ... L1 0...

M12

1210 ... 3...

- 
- |   |   |   |
|---|---|---|
| <a href="#">🔗 1210 1206 ... L1 3...</a> | <a href="#">🔗 1210 1206 ... L2 0...</a> | <a href="#">🔗 1210 1206 ... L2 3...</a> |
| <a href="#">🔗 1220 ... T16CW ...</a>    | <a href="#">🔗 1220 ... T20CW100 ...</a> | <a href="#">🔗 1220 ... T20CW101 ...</a> |
| <a href="#">🔗 1220 ... T20CW102 ...</a> | <a href="#">🔗 1220 ... T20CW103 ...</a> | <a href="#">🔗 1220 ... T20CW104 ...</a> |
| <a href="#">🔗 1220 ... T20CW105 ...</a> | <a href="#">🔗 1221 ... T16CW100 ...</a> | <a href="#">🔗 1221 ... T9CP</a>         |
| <a href="#">🔗 1240 ... T...CR</a>       | <a href="#">🔗 1245 ... T9CR</a>         | <a href="#">🔗 5500 04DL1 3...</a>       |
| <a href="#">🔗 5500 04L1 3...</a>        | <a href="#">🔗 5500 08DL1 3...</a>       | <a href="#">🔗 5500 08L1 3...</a>        |
| <a href="#">🔗 5512 04DL1</a>            | <a href="#">🔗 5512 04L1</a>             | <a href="#">🔗 5512 08L1</a>             |

Accessories

- |                             |                             |                             |
|-----------------------------|-----------------------------|-----------------------------|
| <a href="#">🔗 9912 CPM0</a> | <a href="#">🔗 9912 MRBU</a> | <a href="#">🔗 9912 MRGN</a> |
| <a href="#">🔗 9912 MRRD</a> | <a href="#">🔗 9912 MRWH</a> | <a href="#">🔗 9912 MRYE</a> |
-

M12

1210 ... 3...

Designation	Pole Number	Connected Cable	PU (Pieces)	MDQ (Pieces)	Dimensions L (mm)
1210 04 301 2m	4	PUR, black, 4 x 0.34 mm <sup>2</sup> (AWG 22), 910301, UL-style 20549	5	10	2000
1210 04 301 5m	4	PUR, black, 4 x 0.34 mm <sup>2</sup> (AWG 22), 910301, UL-style 20549	1	10	5000
1210 05 302 0,6m	5	PUR, black, 5 x 0.34 mm <sup>2</sup> (AWG 22), 910302, UL-style 20549	5	10	600
1210 05 302 2m	5	PUR, black, 5 x 0.34 mm <sup>2</sup> (AWG 22), 910302, UL-style 20549	5	10	2000
1210 05 302 5m	5	PUR, black, 5 x 0.34 mm <sup>2</sup> (AWG 22), 910302, UL-style 20549	1	10	5000
1210 08 303 2m	8	PUR, black, 8 x 0.25 mm <sup>2</sup> (AWG 24), 910303, UL-style 20549	5	10	2000
1210 08 303 3m	8	PUR, black, 8 x 0.25 mm <sup>2</sup> (AWG 24), 910303, UL-style 20549	1	10	3000
1210 08 303 5m	8	PUR, black, 8 x 0.25 mm <sup>2</sup> (AWG 24), 910303, UL-style 20549	1	10	5000

**Packaging:**  
in a plastic bag