



JD9 SERIES

KEY SWITCH
 Ø19.2 mm PANEL CUTOUT



KEYSWITCH

ELECTRICAL SPECIFICATION:

CONTACT RATING:	4A 125VAC/28VDC, 2A 250VAC
CONTACT RESISTANCE:	BELOW 10 MILLION OHMS
INSULATION RESISTANCE:	10 ⁹ OHMS Min.
DIELECTRIC STRENGTH:	1000V RMS Min. Sea level
ELECTRICAL LIFE:	6,000 make-and-break cycles at Full load.

PATENT NO. 36076

MATERIALS:

LOCK HOUSING:	ZINC ALLOY DIE-CASTED NICKEL PLATED
CYLINDER:	4 DISC TUMBLER CONSTRUCTION, ZINC ALLOY DIE-CASTED NICKEL PLATED.
KEYS:	BRASS, NICKEL PLATED, SINGLE BITTED.
CONTACTS:	SUPER HARD COPPER ALLOY, GOLD PLATED.
MOUNTING NUT:	ZINC ALLOY DIE CASTED NICKEL PLATED.

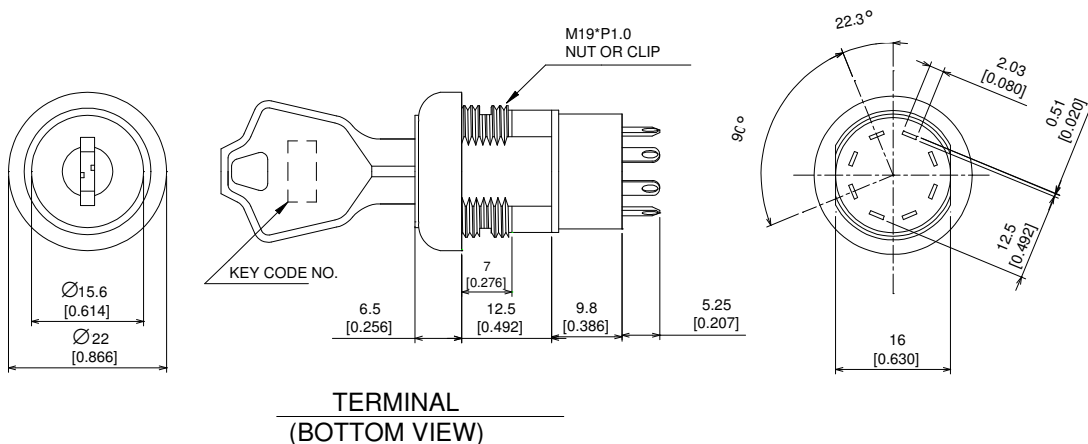

TERMINAL
(BOTTOM VIEW)

LEGEND:

- ▼ = Momentary position (45°)
- = Detent positions (45° or 90°)
- ⊙ = Key pull possible in these positions
- ▼ or ● or ⊙ --- Stop positions.

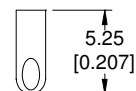
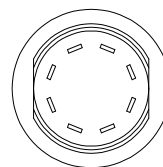



JD9 SERIES

KEY SWITCH
Ø19.2 mm PANEL CUTOUT

LOCK CONFIGURAIION (AS VIEWED FROM KEY END)	MODEL / NO. NO. / POLES	CONNEDCTED TERMINALS					KEY PULL POSSIBLE THESE POS.
		POS.1	POS.2	POS.3	POS.4	POS.5	
 POS.1 2 45° 3 INDEXING	JD9H126W	8-1 4-5	1-2 5-6	7-8 3-4			POS.1
 POS.1 2 45° 3 INDEXING	JD9J126W	8-1 4-5	1-2 5-6	7-8 3-4			POS.1 POS.2 POS.3
 POS.1 90° INDEXING	JD9O126W	8-1 4-5	1-3 5-7				POS.1
 POS.1 90° INDEXING	JD9S126W	8-1 4-5	1-3 5-7				POS.1 POS.2

ATTACHED WIRE SPEC

TERMINAL	LENGTH(mm)	SPEC		
1	250	UL1007	20AWG	BLACK
2	250	UL1007	20AWG	BLUE
3	250	UL1007	20AWG	BROWN
4	250	UL1007	20AWG	GREEN
5	250	UL1007	20AWG	GREY
6	250	UL1007	20AWG	RED
7	250	UL1007	20AWG	VIOLET
8	250	UL1007	20AWG	YELLOW