

PRODUCT NUMBER
SEE P/N SCHEME

NOTES:

- MATERIAL:
HSG: OPTIONS, UL94V-0, OPTIONAL COLORS.
TERMINAL: HIGH CONDUCTIVITY COPPER ALLOY.
PLATING: OPTIONAL ON CONTACT AREA.
- THIS HEADER MATES WITH FCI RECEPTACLE WIRE CONNECTOR 10127815, CRIMPING 10130517 FOR HIGH CURRENT APPLICATION.
- PRODUCT SPECIFICATION: GS-12-1333.
- PACKAGE SPECIFICATION: GS-14-2362.
- THE HOUSING WILL WITHSTAND EXPOSURE TO 235°C PEAK TEMPERATURE FOR 5 SECONDS IN A WAVE SOLDER APPLICATION WITH A 1.6mm MINIMUM THICK CIRCUIT BOARD. (FOR PA66)
THE HOUSING WILL WITHSTAND EXPOSURE TO 260°C PEAK TEMPERATURE FOR 10 SECONDS IN A REFLOW OVEN. (FOR LCP ONLY)
- PART NUMBER SCHEME:
10131318-XX XX XX XX LF
POS. CODE:
02: 2 POS.
24: 24 POS.
S1: SEE SHEET 2
S2: SEE SHEET 2
PLATING CODE:
1: GOLD FLASH
2: 80u" BRIGHT TIN
5: 100u" MATTE TIN
HSG COLOR:
1: NATURAL
2: BLACK
LOCATING PEG:
O: NONE (TRAY)
P: BOTH PEGS (TRAY)
R: NONE (TAPE/REEL)
GLOW WIRE COMPATIBLE:
O: NO, PA66 CM3004
G: YES, PA66 C3U OR LCP E130i
HSG MATERIAL:
1: NYLON 66
2: LCP E130i (-XXXX2GXLF)

7. DIMENSIONAL & PART NO. TABLE:

PART NUMBER	POS.	A	B
10131318-02XXXXXL	02	4.2	5.4
10131318-04XXXXXL	04	4.2	9.6
10131318-06XXXXXL	06	8.4	13.8
10131318-08XXXXXL	08	12.6	18.0
10131318-10XXXXXL	10	16.8	22.2
10131318-12XXXXXL	12	21.0	26.4
10131318-14XXXXXL	14	25.2	30.6
10131318-16XXXXXL	16	29.4	34.8
10131318-18XXXXXL	18	33.6	39.0
10131318-20XXXXXL	20	37.8	43.2
10131318-22XXXXXL	22	42.0	47.4
10131318-24XXXXXL	24	46.2	51.6

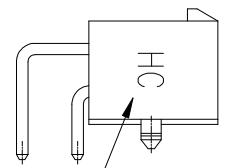
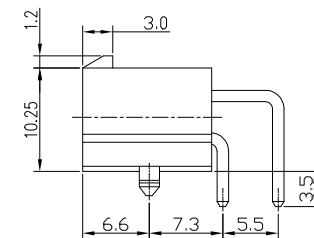
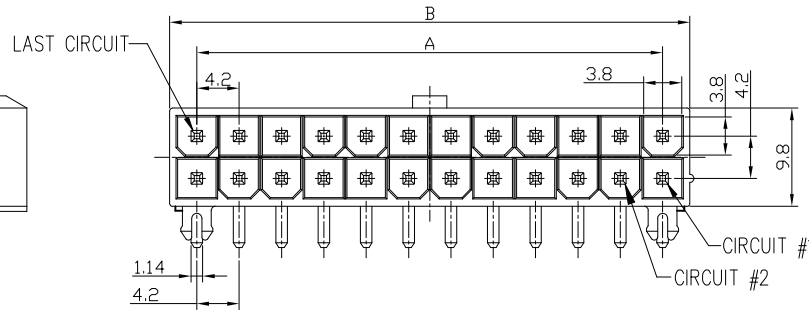
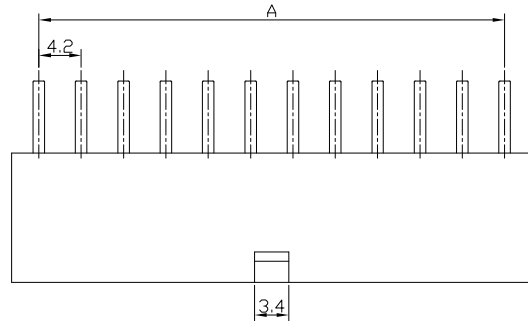

MARK OF "HIGH CURRENT"

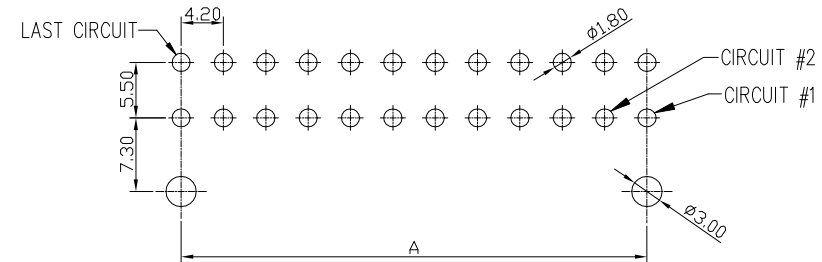
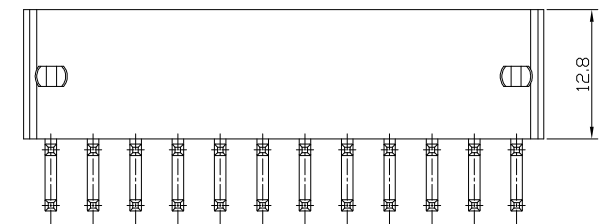

PCB LAYOUT COMPONENT SIDE

mat'l. code		surface <input checked="" type="checkbox"/> tolerance		projection		product family	
ltr		ecn no		dr		date	
A		ELX-T-19532		TAI		2014-08-29	
B		ELX-T-21754		TAI		2015-08-24	
C		ELX-T-24683		TAI		2016-08-09	
D		ELX-T-27707		TONY		2017-08-15	
E		ELX-N-29299		TONY		2018-02-06	
F							
sheet index		revision sheet		F 1		F 2	
tolerances unless otherwise specified		angles		linear		mm	
		X.X±0.4		X.XX±0.30		scale	
X'±1'		KENNY TAI		2014-08-12		KENNY TAI	
K'±1'		KENNY TAI		2014-08-12		KENNY TAI	
K'±1'		PM ZHENG		2014-08-29		PM ZHENG	
MINITEK PWR4.2 HCC		MINITEK PWR4.2 HIGH CURRENT HEADER		DUAL ROW, R/A, DIP TYPE		MINITEK PWR4.2 HCC	
dwg no		sheet 1 of 2		size		A4	
10131318		Product Customer Drawing					



2 POS



10 POS



18 POS



4 POS



12 POS



20 POS



6 POS



14 POS



22 POS



8 POS

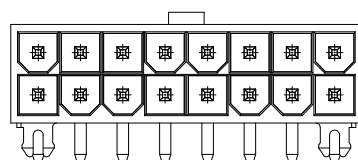

16 POS

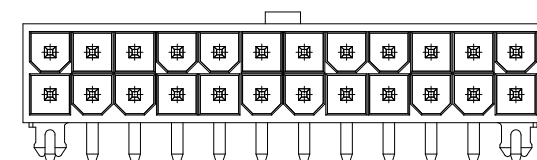

24 POS

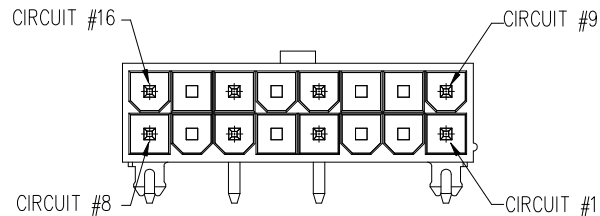

S1: CIRCUIT 2,3,5,7,10,11,13,15 REMOVED

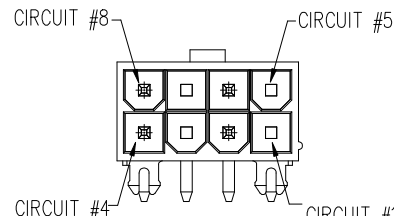

S2: CIRCUIT 1,3,5,7 REMOVED

mat'l. code		surface <input checked="" type="checkbox"/> tolerance		projection		product family				
ltr		ecn no dr		tolerances unless otherwise specified		MINITEK PWR4.2 HCC				
				<table border="1"> <tr> <td rowspan="2">Linear</td> <td>X.X±0.4</td> </tr> <tr> <td>X.XX±0.30</td> </tr> </table>		Linear	X.X±0.4	X.XX±0.30	title	
Linear	X.X±0.4									
	X.XX±0.30									
		angles		mm		MINITEK PWR4.2 HIGH CURRENT HEADER				
		X'±1'		scale		DUAL ROW, R/A, DIP TYPE				
		dr		KENNY TAI 2014-08-12		dwg no				
		enr		KENNY TAI 2014-08-12		sheet 2 of 2 size				
		chr		KENNY TAI 2014-08-12		10131318 A4				
		appd		PM ZHENG 2014-08-29		type Product Customer Drawing				
sheet index		revision sheet		F 1		F 2				