

THIS COPY IS PROVIDED ON A RESTRICTED BASIS AND IS NOT TO BE USED IN ANY WAY DETRIMENTAL TO THE INTERESTS OF PANDUIT CORP.

PANDUIT P/N	WEIGHT
CMMPO****	.17 lbs/10 Pcs [77.2 g/10 Pcs]

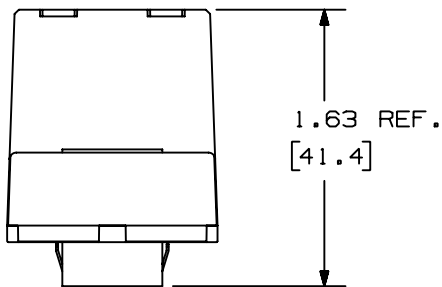

- NOTES:
- SEE CURRENT CATALOG FOR PART NUMBER SUFFIXES TO INDICATE COLOR AND/OR PACKAGE QUANTITIES.
 - SEE CATALOG FOR COMPLETE LIST OF PARTS APPLICABLE FOR USE WITH THIS PART.
 - MATERIALS:
 - ADAPTER HOUSING: PLASTIC
 - MODULE BASE: PLASTIC
 - DUST CAP: PLASTIC
 - DIMENSIONS IN BRACKETS ARE METRIC [mm]

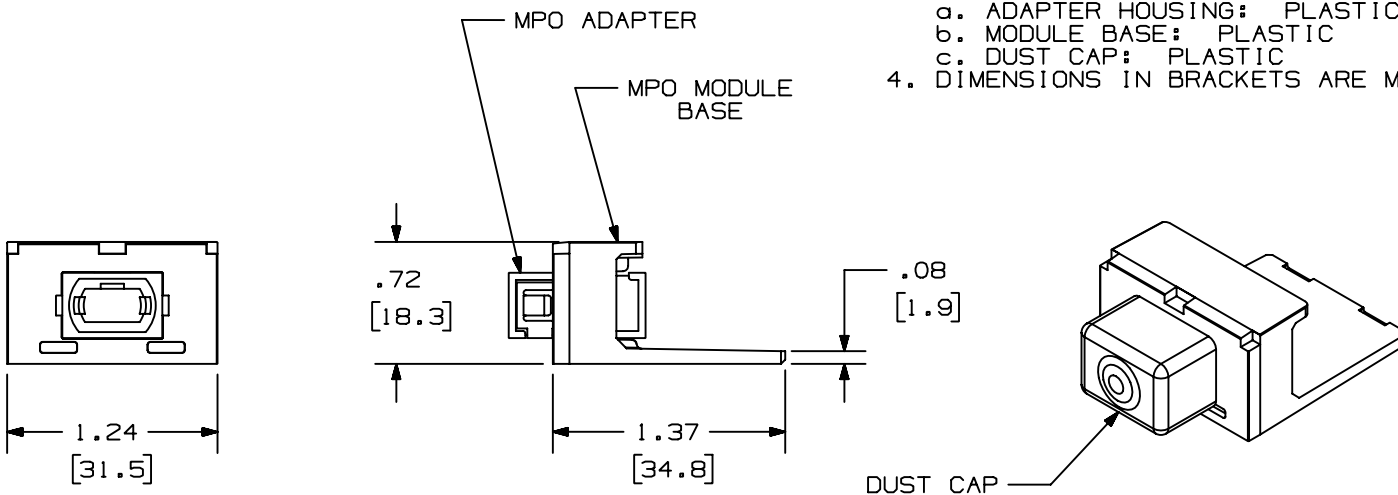

MINI-COM MPO ADAPTER MODULE
CUSTOMER DRAWING



PANDUIT™
CORP.
TINLEY PARK, ILL 60477

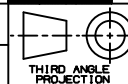

THIRD ANGLE
PROJECTION

ALL DIMENSIONS ARE GIVEN IN INCHES,
UNLESS OTHERWISE SPECIFIED.
DIMENSIONAL TOLERANCES ARE:
(.X) (.XXX) ± .010 [0.3]
(.XX) ± .03 [0.8] ANGLES

DRAWING FILENAME
M01988CC_DC_00A.prt
SCALE
NONE

DRAWN BY
MC
DATE
07-23-04
CHK'D

REVIEW DRAWING NUMBERS

SEE NOTES

PART NO.
CMMPO****
DRAWING NO.
01988-04
SIZE
A

REV	DATE	BY	CHK	DESCRIPTION	ECN	R	CUST	SUP	OTH
R	07-26-04	MC		RELEASED TO PRODUCTION	01988-04				

Mouser Electronics

Authorized Distributor

Click to View Pricing, Inventory, Delivery & Lifecycle Information:

[Panduit:](#)

[CMMPOBLBL](#)