

4M-Series

Miniature Slide Switches

[PRODUCT WEBPAGE](#)

request sample, configure part

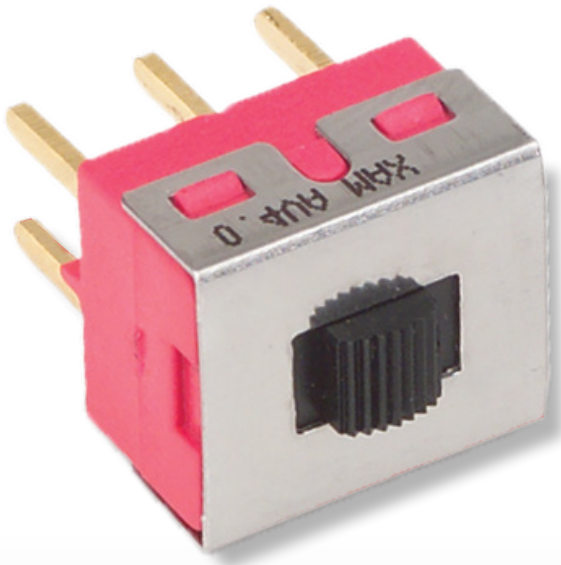
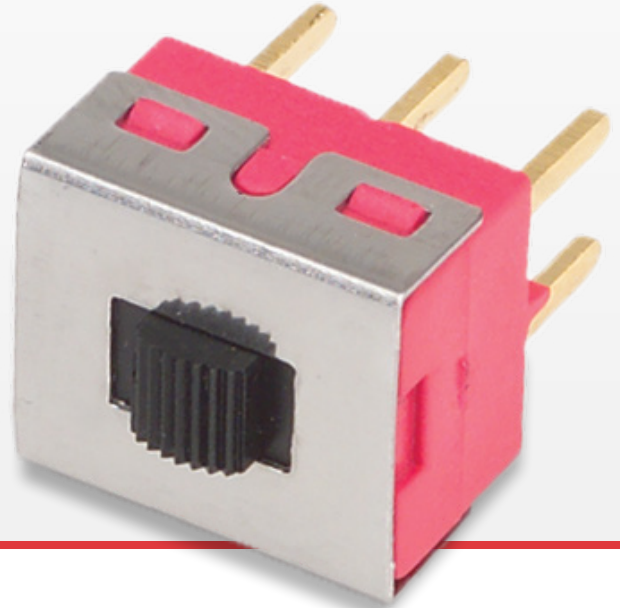

The 4M-Series miniature slide switches offer a variety of ratings, circuits, contact materials, and terminal platings. With 14 termination choices and 8 actuator styles, this versatile switch adapts to a variety of applications, and is able to withstand temperatures from -30°C to +85°C.

1-2 **.4-5** **125, 250** **28**
Poles Amps VAC VDC

Typical Applications

- Consumer Electronics
- Instrumentation
- Computer Servers / Peripherals
- Test / Measurement

Tech Specs

Electrical

Contact Rating	refer to ordering scheme
Electrical Life	30,000 make & break cycles @ full load
Contact Resistance	10 mΩ max. initial @ 2-4 VDC 100mA for both silver & gold plated contacts
Insulation Resistance	1000 MΩ min.
Dielectric Strength	1500 Volts RMS @ sea level

Physical

Operating Temperature	-30°C to +85°C
Solder Heat Resistance	MIL-STD-202, Method 210

Material

Case	Diallyl phthalate (DAP) (UL 94V-0)
Slide Handle	Nylon
Housing	Stainless Steel
Terminal Seal	Epoxy

Ordering Scheme

Sample Part Number

4M1 - SSP 3 - S1 / 2 - M6 Q E

Selection 1 2 3 4 5 6 7

1. SERIES

4M1 Miniature Slide Switch

2. POLES

SSP Single Pole **SDP** Double Pole

3. CIRCUIT

() - momentary
Switching Position: 1 2 3
 1 2-1, 5-4 Connected Terminals 2-3, 5,6
 3 ON NONE ON
 ON OFF ON

4. ACTUATOR

S1 .201" height	S5 .053" height (for DPDT only)
S2 .301" height	S6 .488" height
S3 .370" height	S7 .311" height
S4 .140" height	T1 .209" height (for DPDT only)







5. ACTUATOR COLORS

1 White	6 Green
2 Black	7 Blue
3 Red	8 Brown
4 Orange	9 Gray
5 Yellow	

5. TERMINATION

M1 Solder Lug	M7 PC Mount, 90° vertical
M2 PCB	M71 Snap-In, 90°
M3 Quick Connect	VS2 PC Mount, U bracket, .350 height
M51 Wire Wrap .750	VS3 PC Mount, U bracket, .575 height
M52 Wire Wrap .964	N1 Solder Lug without mounting tabs
M53 Wire Wrap .425	
M54 Wire Wrap 1.062	
M6 PC Mount, 90° horizontal	
M61 Snap-In, 90°	

6. CONTACTS / TERMINALS

Contact Material	Terminal Plating	Rating	Approvals
G silver ¹	gold over silver	5A 125VAC or 28VDC 2A 250VAC	 
K gold ²	tin ^{3,5}	0.4VA max 20V max (AC/DC)	N/A
P silver ¹	tin ^{3,5}	5A 125VAC or 28VDC 2A 250VAC	 
Q silver ¹	silver ¹	5A 125VAC or 28VDC 2A 250VAC	 
R gold ²	gold ²	0.4VA max 20V max (AC/DC)	N/A

7. EPOXY SEAL

E Epoxy Seal **0** without Epoxy Seal

Notes:

- Movable contact & terminal platings: silver over copper alloy
- Movable contact & terminal platings: gold over nickel over copper alloy
- Terminal platings: tin over nickel over copper alloy, available with PC terminations only
- Non-Black, white and red colors require a minimum order of 2500 pieces
- Tin option available with PC type terminations only

 [Configure Complete Part Number >](#)

 [Browse Standard Parts >](#)

Dimensional Specs

inches [millimeters]

Single Pole

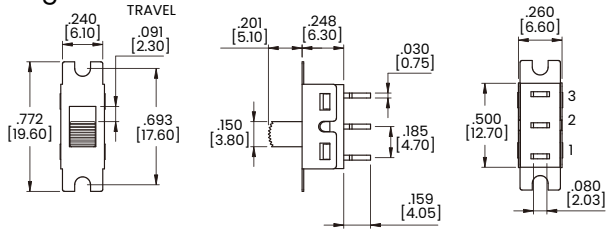

Double Pole

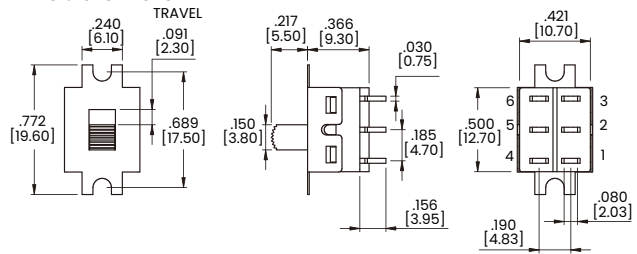

Actuator Options

* All actuator length shown is SPDT model with M1 and M2 terminals.

S1

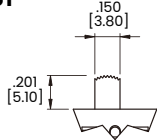

* Add 0.40 (.016) from actuator height for DPDT-M1 and M2 model.

S2

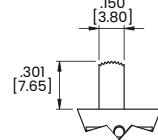

* Add 0.20 (.008) from actuator height for DPDT-M1 and M2 model.

S3

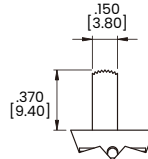

* Add 0.30 (.012) from actuator height for DPDT-M1 and M2 model.

S4

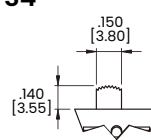

* Add 0.40 (.016) from actuator height for DPDT-M1 and M3 model.

S5

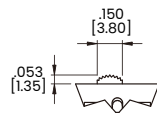

S6

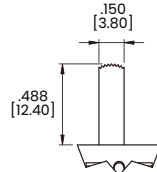

* Add 0.70 (.028) from actuator height for DPDT-M1 and M2 model.

S7

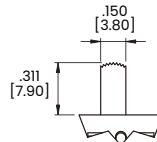

* Add 0.40 (.016) from actuator height for DPDT-M1 and M2 model.

T1 for DPDT only

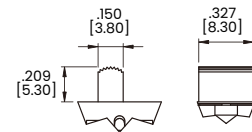

Dimensional Specs

inches [millimeters]

Termination Options

M1 Standard Solder Lug

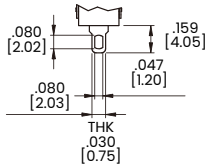

* Standard with Mounting Tabs.

M2 PC Thru-Hole

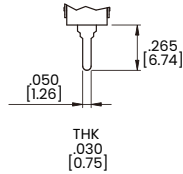

M3 Quick Connect

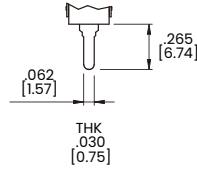

M5 Wire Wrap

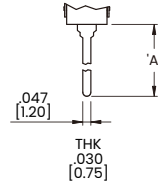

OPTION CODE	DIM.'A'
M5-1	.750 [19.05]
M5-2	.964 [24.48]
M5-3	.425 [10.80]
M5-4	1.062 [26.97]

Termination Options without Mounting Tabs

N1 Single Pole

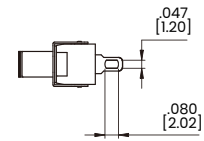
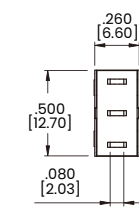
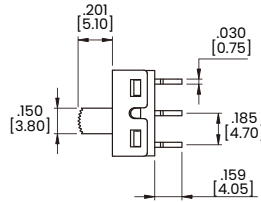
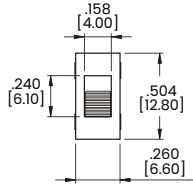

N1 Double Pole

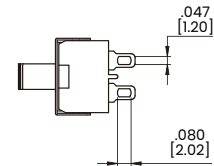
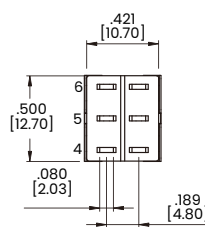
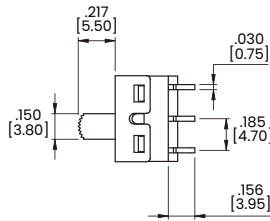
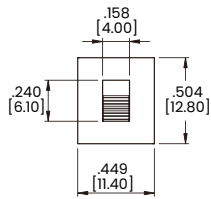

M6 Single Pole

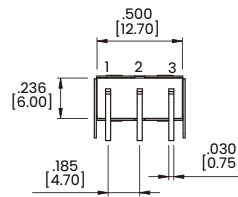
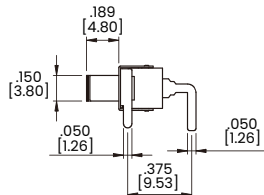
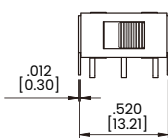

P.C.MOUNTING

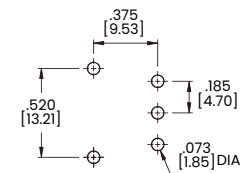

M6 Double Pole

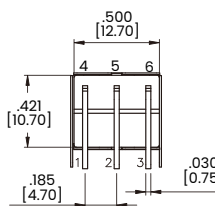
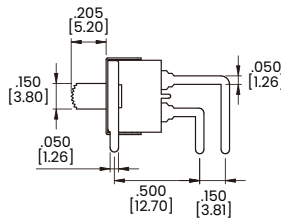
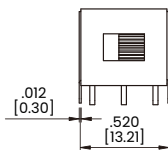

P.C.MOUNTING

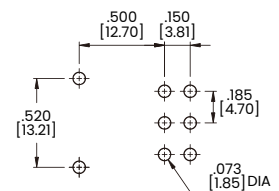

M7 Single Pole

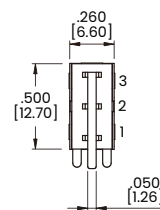
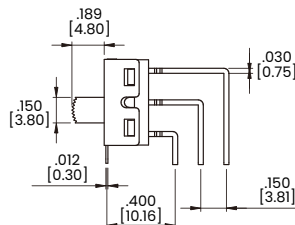
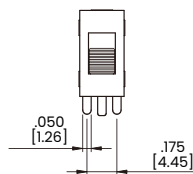

P.C.MOUNTING

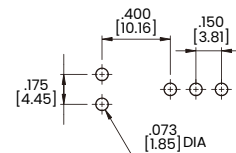

Dimensional Specs

inches [millimeters]

Termination Options

M7 Double Pole

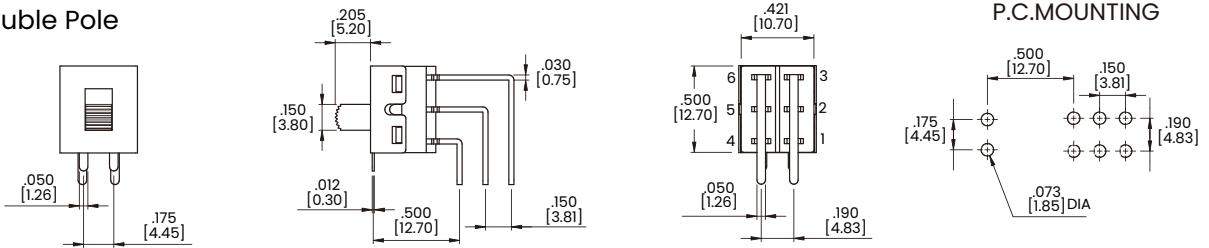

VS2 Single Pole

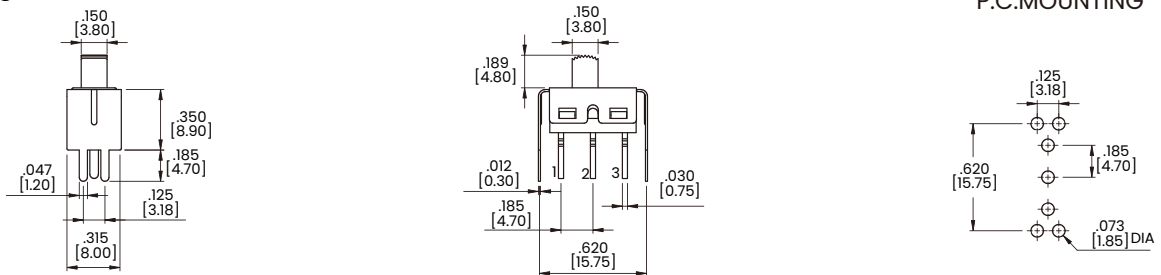

VS2 Double Pole

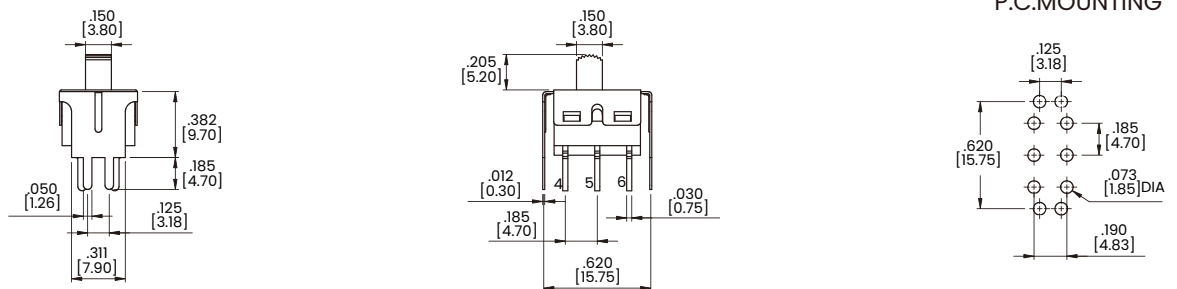

VS3 Single Pole

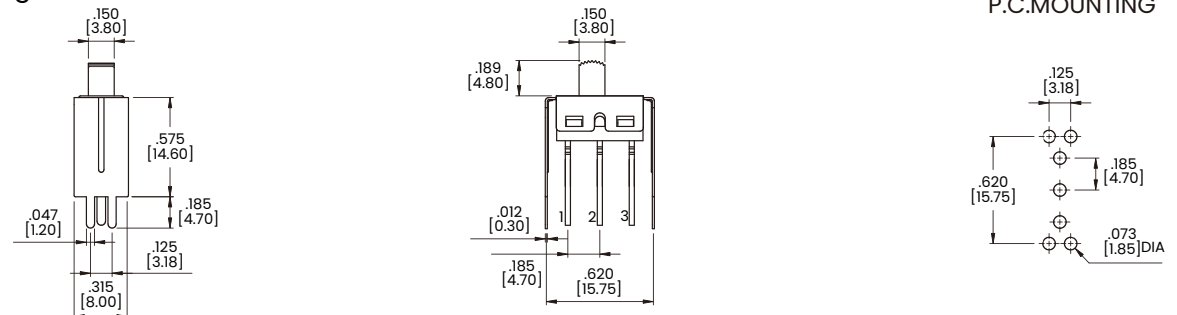

VS3 Double Pole

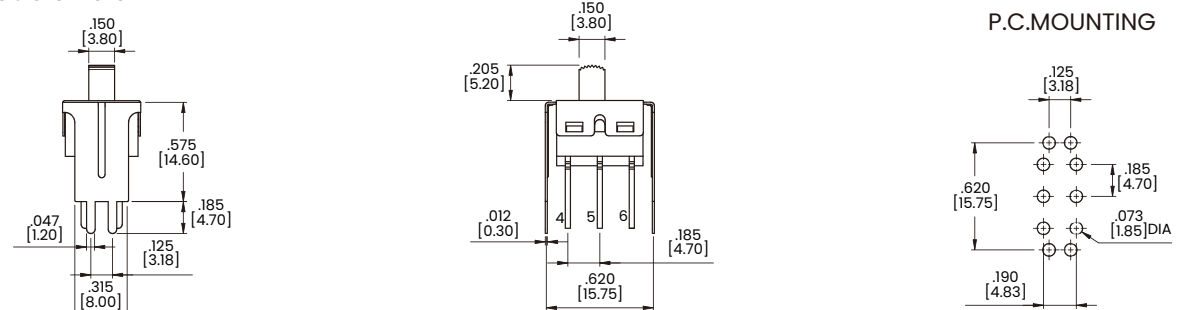

Authorized Sales Representatives and Distributors

Click on a region of the map below to find your local representatives and distributors or visit www.carlingtech.com/findarep.



About Carling

Founded in 1920, Carling Technologies is a leading manufacturer of electrical and electronic switches and assemblies, circuit breakers, electronic controls, power distribution units, and multiplexed power distribution systems. With six ISO9001 and IATF16949 registered manufacturing facilities and technical sales offices worldwide, Carling Technologies Sales, Service and Engineering teams do much more than manufacture electrical components, they engineer powerful solutions! To learn more about Carling please visit www.carlingtech.com/company-profile.

To view all of Carling's environmental, quality, health & safety certifications please visit www.carlingtech.com/environmental-certifications.

© Carling Technologies, Inc.

6. Carling is a registered trademark of Carling Technologies, Inc. in the U.S. and other countries.