

SAMZO REAC/ROHS

REV	ECN NO	DESCRIPTION	DESIGN	APPROVAL	DATE
A1	NEW	Replace frame			2013.06.21

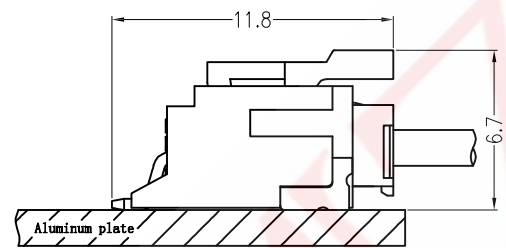

Assembly Layout

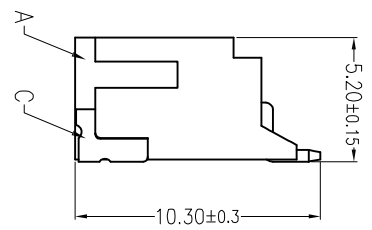
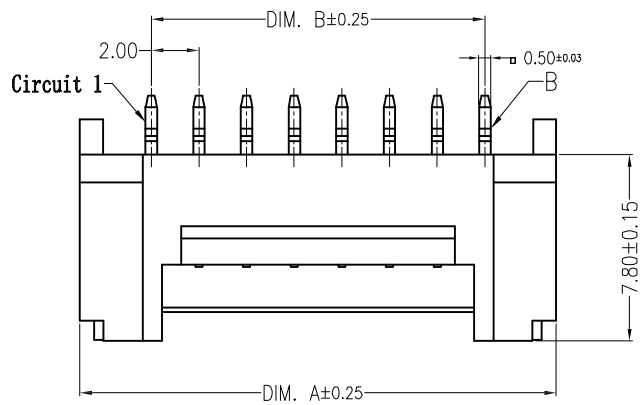
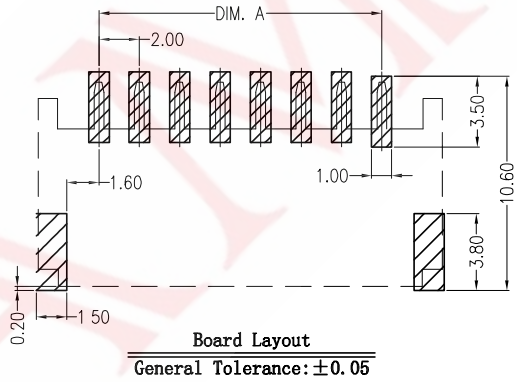
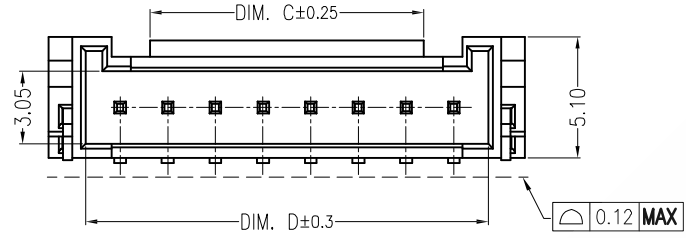

Board Layout
General Tolerance: ±0.05

- ◆ SPECIFICATIONS
- Current rating: 2.0A AC, DC
 - Voltage rating: 250V AC, DC
 - Temperature range: -25°C ~ +105°C
 - Insulation resistance: ≥ 1000MΩ
 - Withstanding voltage: 1000V AC/ minute.
 - Contact resistance: ≤ 20mΩ Max.

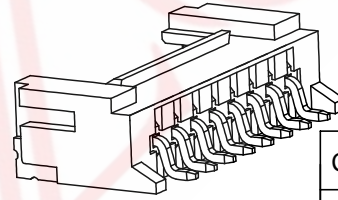

Circuits	Dimension(mm)			
	A	B	C	D
02	8.00	2.00	2.70	4.75
03	10.00	4.00	3.20	6.75
04	12.00	6.00	3.50	8.90
05	14.00	8.00	5.50	10.90
06	16.00	10.00	7.50	12.90
07	18.00	12.00	9.50	14.90
08	20.00	14.00	11.50	16.90
09	22.00	16.00	13.50	18.90
10	24.00	18.00	15.50	20.90
11	26.00	20.00	15.50	22.90
12	28.00	22.00	15.50	24.90
13	30.00	24.00	15.50	26.90
14	32.00	26.00	15.50	28.90
15	34.00	28.00	15.50	30.90
16	16.80	30.00	15.50	32.90

A. SERISE: 6R-HY WITH LOCK
 B. SPACING: K-2.00mm
 C. MOUNTING: D-WT
 D. STANDARD: A-WAFER
 E. PIN: 02-2P (02-16P)
 F. CODE: 0-REGULAR

6RKDA0**
 A B C D E F

ITEM	DESCRIPTION	MATERIAL	QTY	FINSH/COLOR					
1	针脚	黄铜	N	镀锡					
2	主体	PA6T	1	米黄色			GENERAL TOLERANCE		
3	定位片	黄铜	2	镀锡			≥0~2<	±0.15	
					DESIGN	WANGUIFA	2018.06.12	≥2~5<	±0.25
					CHECKED	ZHENGUILAN	2018.06.12	≥0~2<	±0.15
					APPROVED	LILIANJIANG	2018.06.14	≥5	±0.35

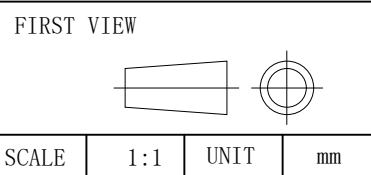

The copyright belongs to samzo parts [China] Co., Ltd. please use the material after samzo parts agree to authorize. The final right of interpretation belongs to samzo parts.
 WWW.KKK-JP.COM

TITLE: HY2.0-WT-WITH LOCK
DWG NO: 6RKD-P2004
PART NO: 6RKD200411
MODEL NO: 6RKDA-**-0
NAME: WAFER CONNECTOR

SAMZO COMPONENTS
 Electronic switch and connector manufacturer