



Capacitor contactor, AC-6b 33 kVAr, / 400 V 1 NO + 2 NC, 110 V AC, 50 Hz 3-pole, Size S0 screw terminal

product brand name	SIRIUS
product designation	capacitor contactors
product type designation	3RT26
General technical data	
size of contactor	S0
product extension auxiliary switch	No
surge voltage resistance	
• of main circuit rated value	6 kV
• of auxiliary circuit rated value	6 kV
maximum permissible voltage for safe isolation between coil and main contacts acc. to EN 60947-1	400 V
shock resistance at rectangular impulse	
• at AC	8,3g / 5 ms, 5,3g / 10 ms
shock resistance with sine pulse	
• at AC	13,5g / 5 ms, 8,3g / 10 ms
mechanical service life (switching cycles)	
• of the contactor with added auxiliary switch block typical	3 000 000
electrical endurance (switching cycles)	150 000
reference code acc. to IEC 81346-2	Q
Substance Prohibitance (Date)	01.05.2014 00:00:00
Ambient conditions	
installation altitude at height above sea level maximum	2 000 m
• ambient temperature during operation	-25 ... +60 °C
• ambient temperature during storage	-55 ... +80 °C
Main circuit	
number of NO contacts for main contacts	3
number of NC contacts for main contacts	0
operational current at AC-6b at 690 V at ambient temperature 60 °C rated value	47.6 A
operating reactive power at AC-6b	
• at 230 V at 50/60 Hz at ambient temperature 60 °C rated value	6 ... 19 kvar
• at 400 V at 50/60 Hz at ambient temperature 60 °C rated value	11 ... 33 kvar
• at 500 V at 50/60 Hz at ambient temperature 60 °C rated value	14 ... 41 kvar
• at 690 V at 50/60 Hz at ambient temperature 60 °C rated value	19 ... 57 kvar

no-load switching frequency • at AC	500 1/h
operating frequency at AC-6b • at 230 V maximum • at 240 V maximum • at 400 V maximum • at 480 V maximum • at 500 V maximum • at 600 V maximum • at 690 V maximum	100 1/h 100 1/h 100 1/h 70 1/h 65 1/h 45 1/h 36 1/h
Control circuit/ Control	
type of voltage	AC
type of voltage of the control supply voltage	AC
• control supply voltage at AC at 50 Hz rated value	110 V
control supply voltage frequency • 1 rated value	50 Hz
operating range factor control supply voltage rated value of magnet coil at AC • at 50 Hz	0.8 ... 1.1
apparent pick-up power of magnet coil at AC	77 V·A
inductive power factor with closing power of the coil	0.82
apparent holding power of magnet coil at AC	9.8 V·A
inductive power factor with the holding power of the coil	0.25
closing delay • at AC	8 ... 40 ms
arcing time	10 ... 15 ms
residual current of the electronics for control with signal <0> • at AC at 230 V maximum permissible	7 mA
Auxiliary circuit	
number of NC contacts for auxiliary contacts • attachable • instantaneous contact	2 0 2
number of NO contacts for auxiliary contacts • attachable • instantaneous contact	1 0 1
operational current of auxiliary contacts at AC-12 maximum	10 A
operational current of auxiliary contacts at AC-15 • at 230 V • at 400 V	6 A 3 A
operational current of auxiliary contacts at DC-13 • at 24 V • at 60 V • at 110 V • at 125 V • at 220 V	6 A 2 A 1 A 0.9 A 0.3 A
contact reliability of auxiliary contacts	0.00000001
UL/CSA ratings	
contact rating of auxiliary contacts according to UL	A600 / Q600
Short-circuit protection	
design of the fuse link • for short-circuit protection of the main circuit with type of coordination 1 required • for short-circuit protection of the auxiliary switch required	gG: 100 A (690 V, 50 kA) gG: 10 A (500 V, 1 kA)
Installation/ mounting/ dimensions	
mounting position	+/-180° rotation possible on vertical mounting surface; can be tilted

	forward and backward by +/- 22.5° on vertical mounting surface
fastening method	screw and snap-on mounting onto 35 mm standard mounting rail according to DIN EN 50022
height	150 mm
width	45 mm
depth	155 mm
required spacing	
• with side-by-side mounting at the side	10 mm
• for grounded parts at the side	10 mm

Connections/ Terminals

type of electrical connection	
• for main current circuit	screw-type terminals
• for auxiliary and control circuit	screw-type terminals
type of connectable conductor cross-sections	
• for main contacts	
— solid	1x (2.5 ... 25 mm²)
— stranded	2x (1 ... 2.5 mm²), 2x (2.5 ... 10 mm²)
— solid or stranded	1x (2.5 ... 25 mm²)
— finely stranded with core end processing	1x (2.5 ... 16 mm²)
• at AWG cables for main contacts	1x (10 ... 4)
type of connectable conductor cross-sections	
• for auxiliary contacts	
— solid	2x (0.5 ... 1.5 mm²), 2x (0.75 ... 2.5 mm²), 2x 4 mm²
— solid or stranded	2x (0.5 ... 1.5 mm²), 2x (0.75 ... 2.5 mm²), 2x 4 mm²
— finely stranded with core end processing	2x (0.5 ... 1.5 mm²), 2x (0.75 ... 2.5 mm²)
• at AWG cables for auxiliary contacts	2x (20 ... 16), 2x (18 ... 14), 2x 12
type of minimum connectable cross-section for main contacts at AC-6b	
• at 40 °C	1x 16 mm²
• at 60 °C	1x 25 mm²
AWG number as coded connectable conductor cross section for main contacts	10 ... 4

Safety related data

product function	
• mirror contact acc. to IEC 60947-4-1	No
• positively driven operation acc. to IEC 60947-5-1	No
protection class IP on the front acc. to IEC 60529	IP20
touch protection on the front acc. to IEC 60529	finger-safe, for vertical contact from the front

Certificates/ approvals

General Product Approval	EMC	Declaration of Conformity
---------------------------------	------------	----------------------------------



Declaration of Conformity	Test Certificates	Marine / Shipping	other
----------------------------------	--------------------------	--------------------------	--------------

[Miscellaneous](#)

[Type Test
Certificates/Test
Report](#)



[Confirmation](#)



Further information

Information- and Downloadcenter (Catalogs, Brochures,...)
<https://www.siemens.com/ic10>

Industry Mall (Online ordering system)

<https://mall.industry.siemens.com/mall/en/en/Catalog/product?mlfb=3RT2628-1AF05>

Cax online generator

<http://support.automation.siemens.com/WW/CAXorder/default.aspx?lang=en&mlfb=3RT2628-1AF05>

Service&Support (Manuals, Certificates, Characteristics, FAQs,...)

<https://support.industry.siemens.com/cs/ww/en/ps/3RT2628-1AF05>

Image database (product images, 2D dimension drawings, 3D models, device circuit diagrams, EPLAN macros, ...)

http://www.automation.siemens.com/bilddb/cax_de.aspx?mlfb=3RT2628-1AF05&lang=en

Characteristic: Tripping characteristics, I^2t , Let-through current

<https://support.industry.siemens.com/cs/ww/en/ps/3RT2628-1AF05/char>

Further characteristics (e.g. electrical endurance, switching frequency)

<http://www.automation.siemens.com/bilddb/index.aspx?view=Search&mlfb=3RT2628-1AF05&objecttype=14&gridview=view1>

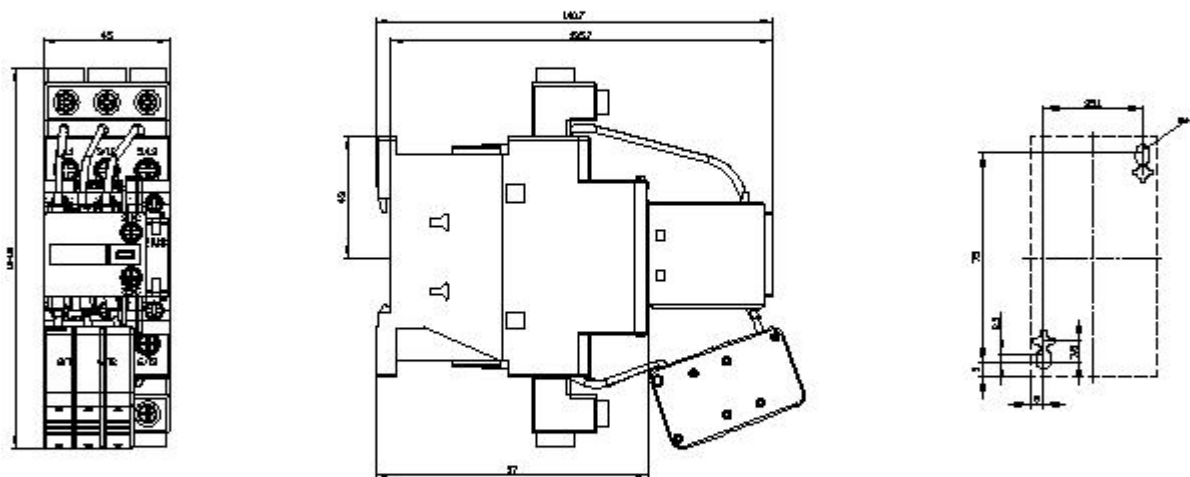

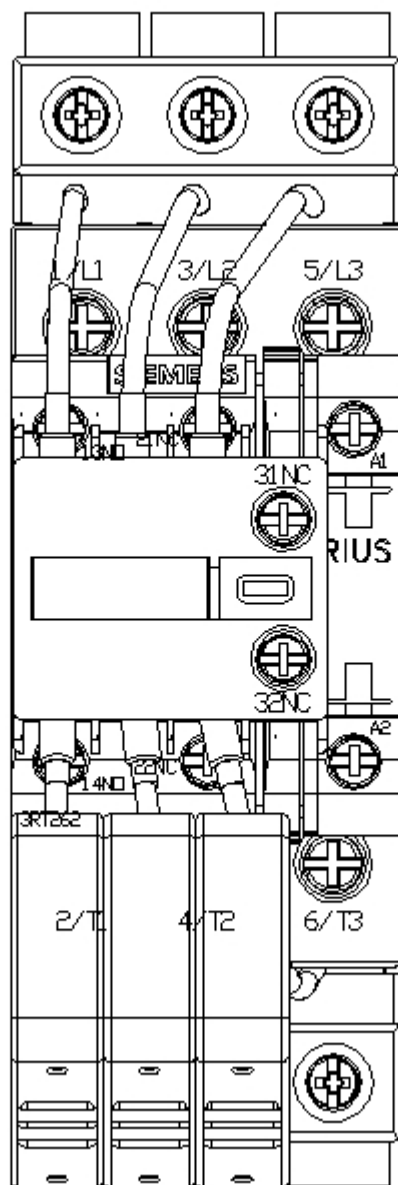

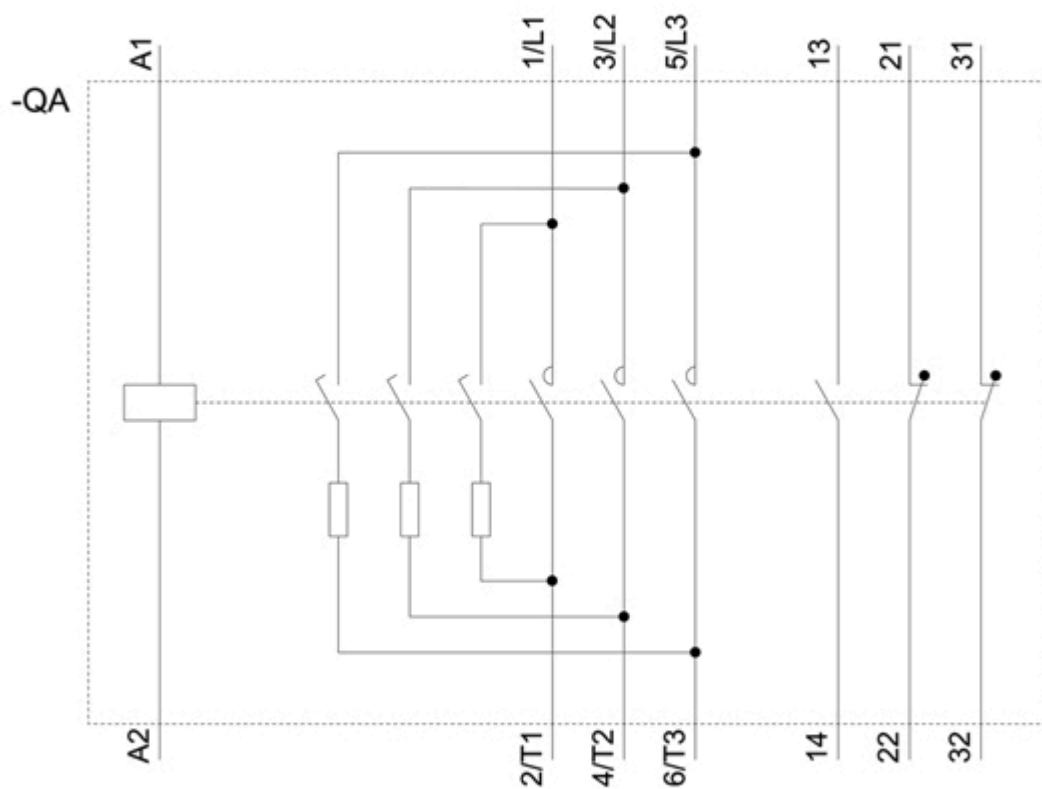

last modified:

12/15/2020 