

Low Loss 4-way Wilkinson Splitter 698 MHz - 2700 MHz 5502.17.0032

Wilkinson Splitter

Description

This series of Wilkinson style Power Dividers has been designed for 50W low power applications where output isolation is preferable over lowest possible loss. The wide frequency range of this design allows use with multiband antennas and leaky cable systems. Lower loss dividers which enhance receive sensitivity and preserve transmitted power are available as reactive splitters.



Technical Data

Electrical Data

Signal Band 1	
Frequency	0.698 - 2.7 GHz
Return Loss input port	17 dB
Return Loss output port	17 dB
Splitter Loss	6 dB
Insertion Loss	6.9 dB
Isol. between Output ports	20 dB
Ampl. tra. betw. outp. ports	0.4 dB
Max. Composite Power	50 W

Input 1	
Connector Type	N
Gender	jack (female)

	Output 1	Output 2	Output 3	Output 4
Connector Type	N	N	N	N
Connector Gender	jack (female)	jack (female)	jack (female)	jack (female)

Char. impedance	50 Ω
-----------------	------

Mechanical Data

Dimensions 26 x 101 x 71 mm (Height x Width x Length)
 Weight 0.395 kg

Environmental Data

Environmental conditions indoor
 Operation temperature -30 °C to 60 °C
 Storage temperature -30 °C to 60 °C
 Transport temperature -30 °C to 60 °C
 RoHS 2011/65/EU compliant

Related Documents

Outline drawing DPR-00172368
 3D-model (Step) DOC-0000369312

Low Loss 4-way Wilkinson Splitter 698 MHz - 2700 MHz 5502.17.0032

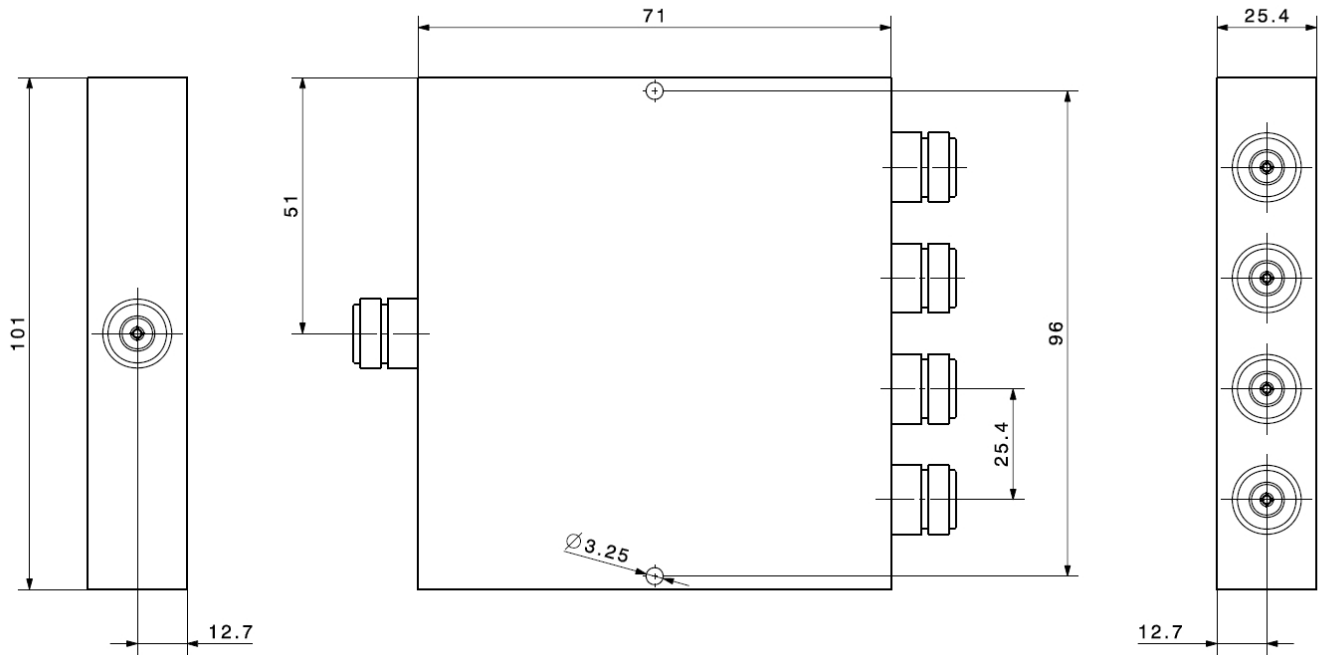

Mouser Electronics

Authorized Distributor

Click to View Pricing, Inventory, Delivery & Lifecycle Information:

[HUBER+SUHNER:](#)

[5502.17.0032](#)