

Jul.1.2024 Copyright 2024 HIROSE ELECTRIC CO., LTD. All Rights Reserved.
 In case of consideration for using Automotive equipment / device which demand high reliability, kindly contact our sales window correspondents.

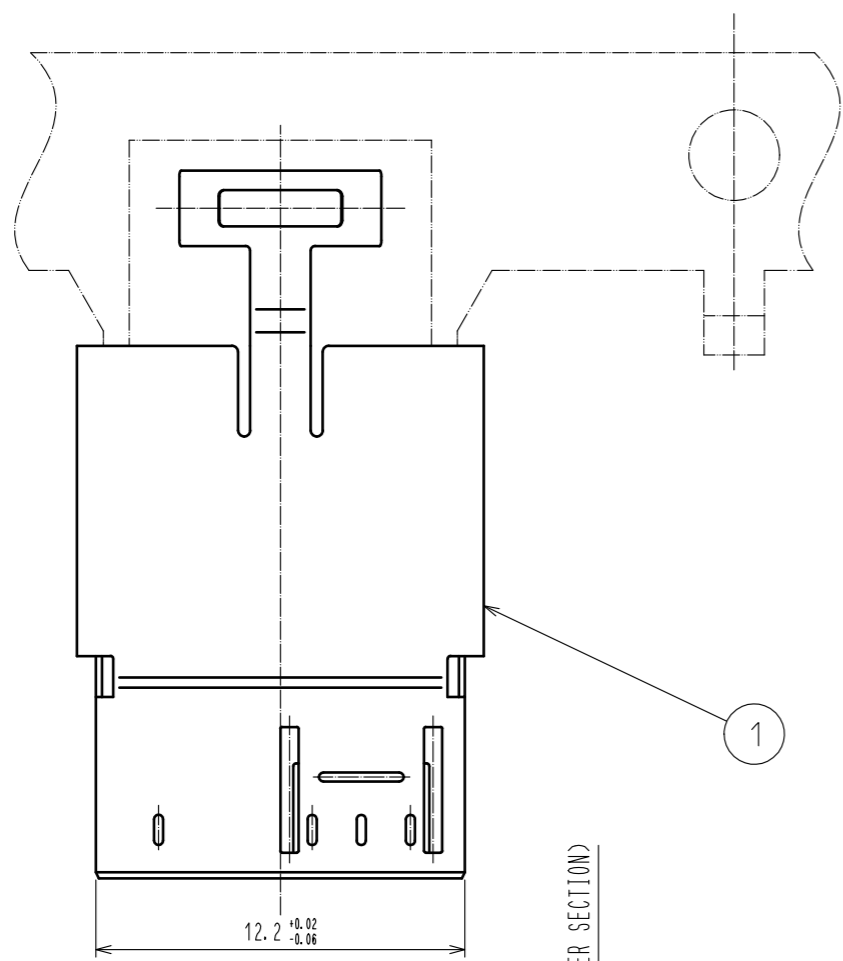

1 Fig-1 DRAWING FOR PACKING (FREE)

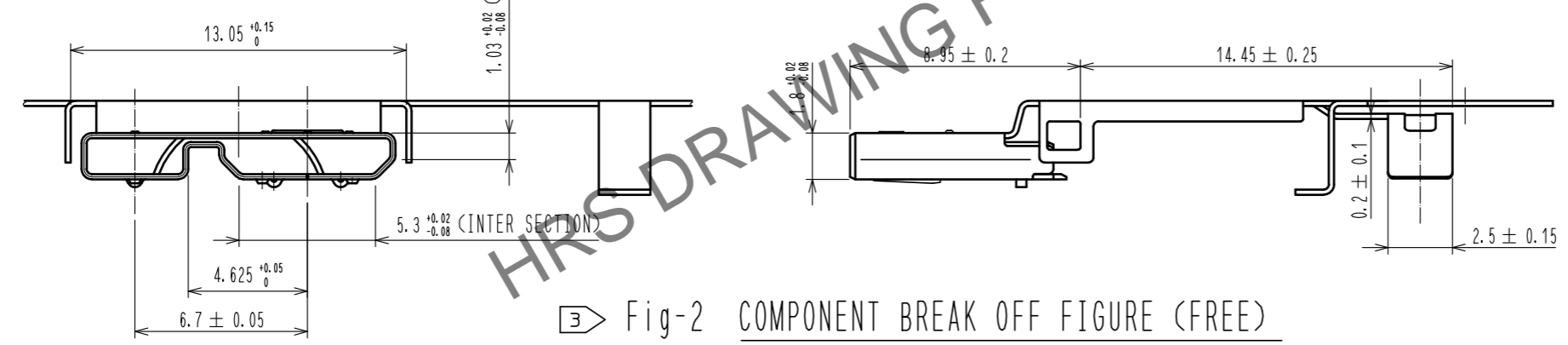
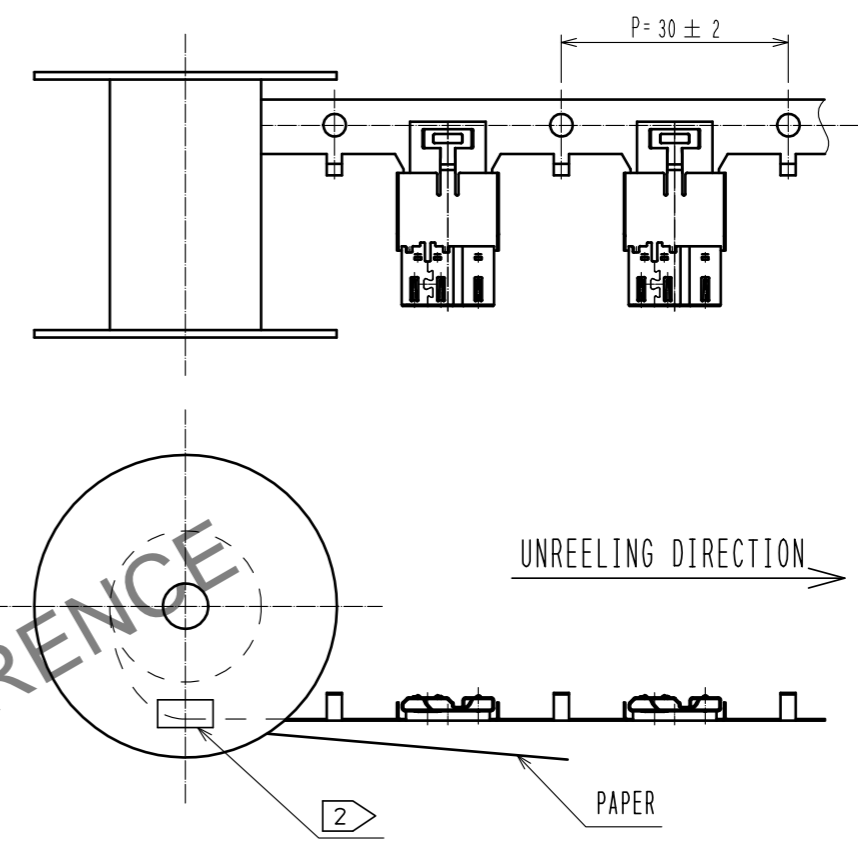

3 Fig-2 COMPONENT BREAK OFF FIGURE (FREE)

3	Halogen-Free
	Lead Free Process
	RoHS Compliant

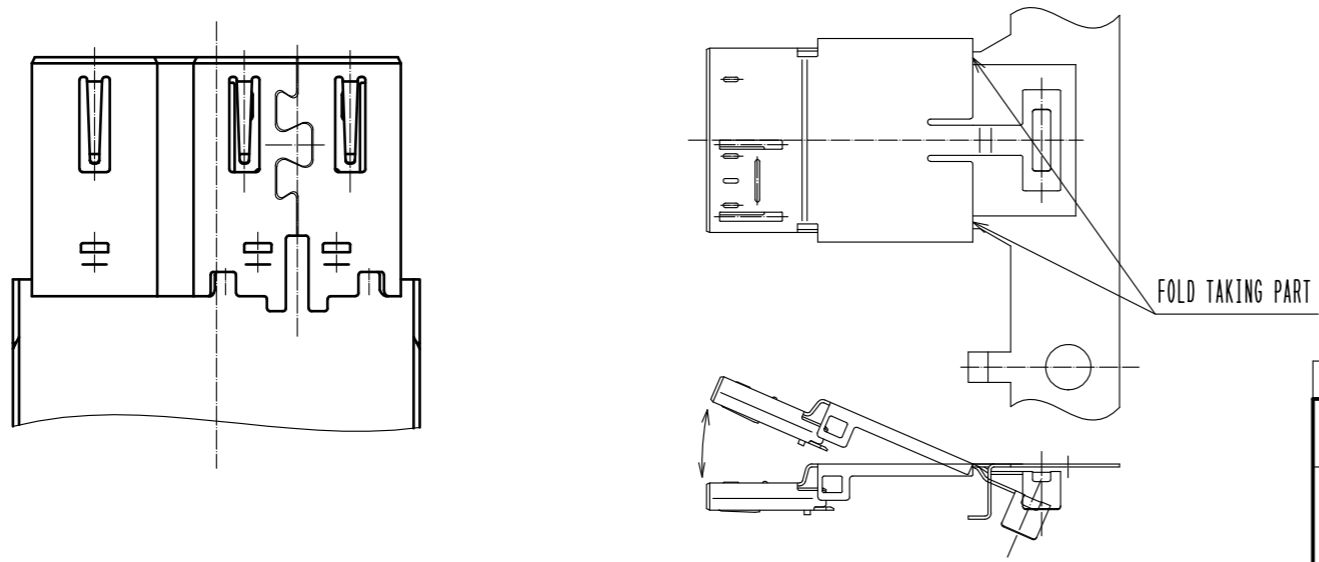

- NOTE
- 1 THIS IS DELIVERED BY A REEL. QTY : 2700 PCS.
 - 2 INDICATE 'Part No.', 'CL No.', 'Lot No.', AND QUANTITY ON BOTH REEL AND THE SIDE SURFACE OF THE SHIPPING OUTER BOX.
 - 3 REMOVE THE COMPONENT FROM THE CARRIER FOR USE AS SHOWN IN Fig.2.

NO.	MATERIAL	FINISH . REMARKS	NO.	MATERIAL	FINISH . REMARKS		
1	STAINLESS STEEL	NICKEL PLATING 0.1μm min					
UNITS	mm	SCALE	COUNT	DESCRIPTION OF REVISIONS	DESIGNED	CHECKED	DATE
		4 : 1	1	DIS-E-00001801	YS. SAKODA	AH. KODAMA	20181004
HRS HIROSE ELECTRIC CO., LTD.		APPROVED : A0. SUZUKI	20100807	DRAWING NO. EDC-127030-00-00			
		CHECKED : KN. ICHIKAWA	20100807	PART NO. ZX360-B-SLDA			
		DESIGNED : TY. MIURA	20100806	CODE NO. CL242-0502-7-00			
		DRAWN : TY. MIURA	20100806			1/1	