

# Data sheet

## PT091xxVGBN Typ 373

### Illustrations

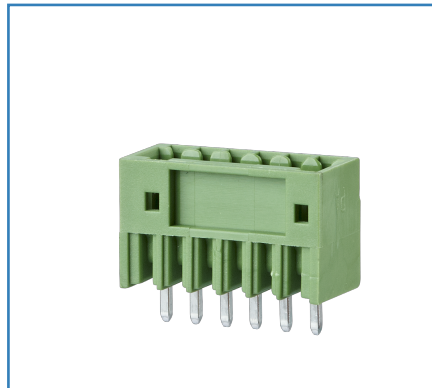

Dimensional drawing

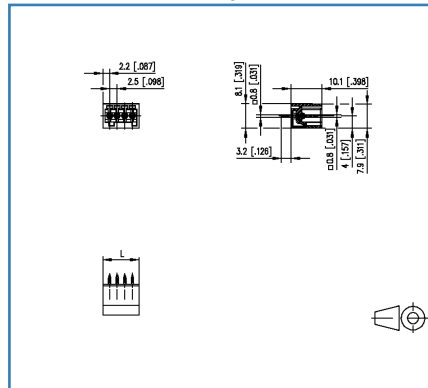

Drill pattern

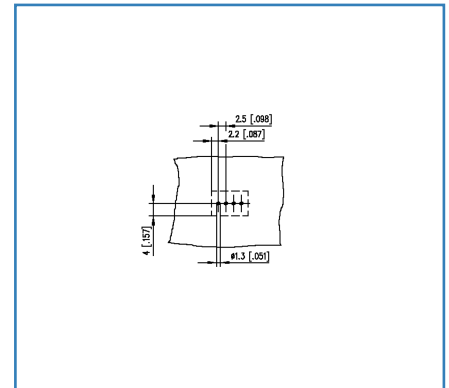

See enlarged drawings at the end of document

### Product specification



- pin header, solderable
- centerline 2.50 mm, direction of connection vertical 0°
- closed ends
- color black

## Technical Data

### General Data

Solder pin length	3.2 mm		
min. number of poles	2		
max. number of poles	12		
Insulating material class	CTI 600		
clearance/creepage dist.	1.7 mm		
protection category	IP00		
Overvoltage category	III	III	II
Pollution degree	3	2	2
Rated voltage	80 V	320 V	320 V
Rated test voltage	2.5 kV	2.5 kV	2.5 kV

### Approvals

 V / A	150 / 5
approval UL - File No.	E121004
 1.5 mm <sup>2</sup>	80 V / 2.5 kV / 6 A / 0.8 x 0.8 mm

### Material

insulating material	PA66
flammability class	V0
contact pin material	CuFe
contact pin surface	Ni + Sn
Glow-Wire Flammability GWFI	960 °C acc. to IEC 60695-2-12
Glow-Wire Flammability GWIT	775 °C acc. to IEC 60695-2-13

### Climatic Data

upper limit temperature	105 °C
lower limit temperature	-40 °C

### General

Tolerance	ISO 2768 -mH
Solderability	Acc. to JEDEC JESD22-B102E 245°C/5s

### Accessories

P/N	Designation
720062-01-8	F_Kodier_ASP051_rtf

© 2019 METZ CONNECT - Technische Änderungen vorbehalten! Subject to modifications! Sous réserve de modifications techniques!



## Data sheet PT091xxVGBN Typ 373

Page 4/6

P/N  
313731xx

xx=number of poles

2019/10/29

Version: Q

### Counterpart of

P/N	Designation
ASP051	SP051xxVGNN ASP051

© 2019 METZ CONNECT - Technische Änderungen vorbehalten! Subject to modifications! Sous réserve de modifications techniques!



**Illustrations**

Dimensional drawing

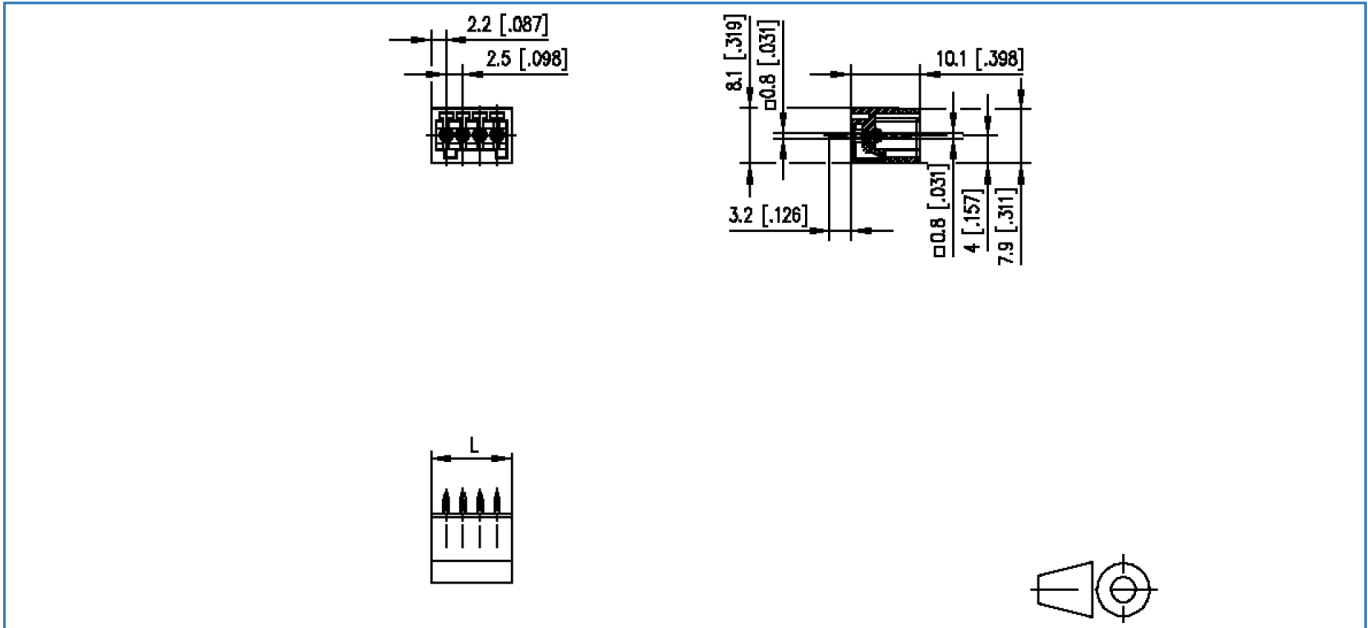

$L = (\text{pole size} - 1) \times \text{centerline} + 4.4 \text{ mm} [0.173]$

© 2019 METZ CONNECT - Technische Änderungen vorbehalten! Subject to modifications! Sous réserve de modifications techniques!

**Illustrations**

Drill pattern

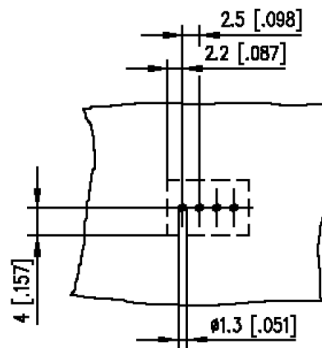

© 2019 METZ CONNECT - Technische Änderungen vorbehalten! Subject to modifications! Sous réserve de modifications techniques!